

Committee: **Licensing Sub Committee**

Date: **Monday 19 November 2012**

Time: **10.00 am**

Venue **John Paul II Centre, Henley House, The Causeway,
Bicester OX26 6AW**

Membership

Councillor Fred Blackwell
Councillor G A Reynolds

Councillor Timothy Hallchurch MBE

AGENDA

1. Constitution of the Sub Committee

The Membership of the Sub-Committee for this meeting will be Councillors Blackwell, Hallchurch and Reynolds.

Please contact Louise Aston (01295 221601) to tender apologies.

2. Declarations of Interest

Members are asked to declare any interest and conflicts that they may have in any of the items under consideration at this meeting.

Note: Any Member with a conflict may not be able to participate in the hearing, and should therefore notify the Head of Legal and Democratic Services in advance so that arrangements may be made for an alternate Member to attend.

3. Premise Licence Determination Hearing (Pages 1 - 100)

Report of Head of Public Protection and Development Management.

Summary

To provide an outline of an application for the grant of a Premises Licence in relation to Vue Cinema, Bure Place, Bicester and detail the representations received from Interested Parties that have resulted in the need for a hearing to determine the application.

Recommendation

There is no recommendation. In considering the representations received and what is appropriate for the promotion of the licensing objectives, the options open to the Sub-Committee are, in broad terms:

- (1) approve the application for the grant of a premises licence as submitted
- (2) reject the application for the grant of premises licence in whole or part
- (3) place conditions on the grant of premises licence and/or require changes to the details of the permissions sought.

Information about this Agenda

Apologies for Absence

Apologies for absence should be notified to democracy@cherwellandsouthnorthants.gov.uk or 01295 221601 prior to the start of the meeting.

Declarations of Interest

Members are asked to declare interests at item 2 on the agenda or if arriving after the start of the meeting, at the start of the relevant agenda item.

Local Government and Finance Act 1992 – Budget Setting, Contracts & Supplementary Estimates

Members are reminded that any member who is two months in arrears with Council Tax must declare the fact and may speak but not vote on any decision which involves budget setting, extending or agreeing contracts or incurring expenditure not provided for in the agreed budget for a given year and could affect calculations on the level of Council Tax.

Access to Meetings

If you have any special requirements (such as a large print version of these papers or special access facilities) please contact the officer named below, giving as much notice as possible before the meeting.

Mobile Phones

Please ensure that any device is switched to silent operation or switched off.

Queries Regarding this Agenda

Please contact Louise Aston, Democratic and Elections
louise.aston@cherwellandsouthnorthants.gov.uk, 01295 221601

Sue Smith
Chief Executive

Published on Friday 9 November 2012

This page is intentionally left blank

Licensing Sub-Committee

Premise Licence Determination Hearing

19 November 2012

Report of Head of Public Protection and Development Management

PURPOSE OF REPORT

To provide an outline of an application to for the grant of a Premises Licence in relation to Vue Cinema, Bure Place, Bicester and detail the representations received from Interested Parties that have resulted in the need for a hearing to determine the application.

This report is public

Recommendations

There is no recommendation. In considering the representations received and what is appropriate for the promotion of the licensing objectives, the options open to the Sub-Committee are, in broad terms:

- (1) approve the application for the grant of a premises licence as submitted
- (2) reject the application for the grant of premises licence in whole or part
- (3) place conditions on the grant of premises licence and/or require changes to the details of the permissions sought.

Executive Summary

Introduction

- 1.1 On 24 September 2012, the Licensing Authority received an application for the grant of a premises licence to permit regulated entertainment, provision of entertainment facilities, provision of late night refreshment and Sale by retail of alcohol at Vue Cinema, Bure Place in Bicester.
- 1.2 The Licensing Act 2003 provides a clear focus on the promotion of four statutory objectives which must be addressed when licensing functions are undertaken.

1.3 The licensing objectives are:

- The prevention of crime and disorder.
- Public safety.
- The prevention of public nuisance.
- The protection of children from harm.

The Guidance issued under Section 182 of the Licensing Act 2003 states:

Each objective is of equal importance. It is important to note that there are no other licensing objectives, so that these four objectives are paramount considerations at all times. But the legislation also supports a number of other key aims and purposes. These are vitally important and should be principal aims for everyone involved in licensing work. They include:

- *the necessary protection of local residents, whose lives can be blighted by disturbance and anti-social behaviour associated with the behaviour of some people visiting licensed premises of entertainment;*
- *the introduction of better and more proportionate regulation to give business greater freedom and flexibility to meet customers' expectations;*
- *greater choice for consumers, including tourists, about where, when and how they spend their leisure time;*
- *the encouragement of more family friendly premises where younger children can be free to go with the family;*
- *the further development within communities of our rich culture of live music, dancing and theatre, both in rural areas and in our towns and cities.*

1.4 For the Licensing Authority to accept a representation as relevant, it must firstly address one or all of the four licensing objectives and the likely effect of the grant of the premises licence upon the promotion of those objectives. The licensing authority must then determine whether or not the representation may be deemed frivolous, vexatious or repetitious and that they have been received within the relevant timescales. The licensing authority can take whole or part of a representation and deem it as relevant, therefore excluding the irrelevant part from the proceedings.

1.5 During the consultation period the Licensing Authority received representations from a number of Interested Parties. Full details of all relevant representations received are included at paragraph 2 of this report.

Proposals

1.6 The applicant has proposed to provide the following regulated activities for the days and times specified:

Plays; Live Music / Recorded Music; Performance of Dance; Provision of

facilities for Making Music; Provision of facilities for Dancing;

Monday – Sunday inclusive from 09:00 to 03:00 the following morning,
indoors only

Films

Monday – Sunday inclusive for 24 hours, indoors only

Late Night Refreshment;

Monday – Sunday inclusive from 23:00 to 05:00 the following morning,
indoors and outdoors

Sale(by retail) of Alcohol;

Monday – Sunday inclusive from 09:00 to 02:30 the following morning
For consumption on the premises only

1.7 The applicant has proposed the following opening hours for the premises:

Monday – Sunday inclusive for 24 hours

1.8 In addition to the above times, the applicant has requested the following non standard timings for all licensable activities permitted by the premises licence:

- An additional hour on the day that British Summertime commences
- From the end of permitted hours on New Year's Eve to the start of permitted hours on New Year's Day

Background Information

- 2.1 A full copy of the application, including plans of the location to be licensed submitted by the applicant is attached at Appendix 1.
- 2.2 During the consultation period, a total of 53 representations were received in respect of this application from 42 individual addresses.
- 2.3 On 24 September 2012, the Licensing Authority received a response to the application from Trading Standards advising they had no objections to the application. A copy of the correspondence is attached at Appendix 2.
- 2.4 On 10 October 2012, the Licensing Authority received a response to the application from Oxfordshire County Council Fire and Rescue Service advising they had no objections to the application. A copy of the correspondence is attached at Appendix 3.
- 2.5 On 26 September 2012, the Licensing Authority received a response to the application from the Anti Social Behaviour Manager at Cherwell District

Council advising they had no objections to the application. A copy of the correspondence is attached at Appendix 4.

- 2.6 At the end of the consultation period, Rob Lowther, the Anti Social Behaviour Manager reviewed the responses from interested parties that had referred to a potential for noise nuisance or anti social behaviour coming from the premises. Whilst Mr Lowther still has no objections to the application, he prepared a response in relation to the points raised. This response is attached to the report as Appendix 5.
- 2.7 On 24 September 2012, an email was sent by Laura Morris, Licensing Officer for Thames Valley Police, requesting the applicant amended their application to refer to Thames Valley Police rather than the Metropolitan Police. This was agreed by the applicant's solicitor. Further to this, on 25 September 2012, the Licensing Authority received a response to the application from the Thames Valley Police advising they had no objections to the application. A copy of the correspondence is attached at Appendix 6 and 7 respectively.
- 2.8 By 12 October 2012, 7 objections had been received from interested parties opposing the application. As a result, the applicant's solicitor arranged for a meeting to be held on 16 October 2012 with the applicant to discuss their concerns. The meeting was attended by Mr Kam Dosanjh, Operations Manager for Vue Cinema, Claire Bold, Licensing Team Leader at Cherwell District Council and interested parties who had made representation up until this date.
- 2.9 On 17 October 2012, Claire Bold wrote to all attendees and the applicant summarising the main points that were raised at the meeting. A copy of the letter sent is attached to the report at Appendix 8.
- 2.10 Some of the concerns raised at the meeting were not directly attributed to the premises licence application and were more concerned with the whole development in Bure Place, Bicester. As a result, these concerns have been forwarded to the relevant departments in Cherwell District Council and Oxfordshire County Council to be addressed.
- 2.11 By the end of the consultation period, 53 objections had been received opposing the application. All of the objections were concerned with the opening times of the premises, the possibility of associated noise nuisance from persons leaving the premises on foot and by car, the sale of alcohol and possible disturbance from light pollution. Full copies of all the objections received from interested parties are attached to this report at Appendix 9.
- 2.12 On 23 October 2012, further correspondence was received from Mr Clark-Dunn and Councillor Mould in addition to their initial objections. Copies of this correspondence are included in Appendix 9.
- 2.13 On 23 October 2012, a representation opposing the application and suggesting amendments to the proposed premises licence was submitted by Councillor Lawrie Stratford, on behalf of the local residents. Councillor Stratford's objection is attached to the report at Appendix 9.
- 2.14 A Map showing the location of the premises in relation to the location of the Interested Party properties is attached at Appendix 10.

Key Issues for Consideration/Reasons for Decision and Options

3.1 The Licensing Act 2003 states that all licensing matters must promote the four Licensing Objectives, they are:

- The prevention of crime and disorder;
- Public safety;
- The prevention of public nuisance; and
- The protection of children from harm

3.2 Representations received have stated concerns in relation to potential issues in respect of the prevention of crime and disorder and the prevention of public nuisance.

3.3 Details of how the applicant intends to promote the four licensing objectives in general in addition to specifically related to promotion of the prevention of crime and disorder objective and the promotion of the prevention of public nuisance objective is given below:

Objective	Applicants response
General	See below
Prevention of crime & disorder	<ol style="list-style-type: none"> 1. Notices stating that CCTV is in operation will be displayed throughout the venue; 2. A tamper proof CCTV system shall be installed, maintained and operated at the premises in liaison with and to the satisfaction of Thames Valley Police and shall be used to record during all hours the premises are open to the public. 3. Sale of alcohol will cease at 02:30 or 30 minutes before the end of the last film showing at the premises whichever is the earlier 4. Each auditoria is visited by a member of staff during film showings to monitor screens and the behaviour of customers. These staff are issued with night vision goggles or equivalent.
Prevention of public nuisance	<ol style="list-style-type: none"> 1. Considering the nature and location of the premises it is not considered that any steps are required to promote this licensing objective.

3.4 The relevant sections of the Guidance and Licensing Authority Policy issued under the Licensing Act 2003, which are applicable to the representations for this case are as follows:

**GUIDANCE ISSUED UNDER SECTION 182 OF THE LICENSING ACT 2003,
APRIL 2012:**

Pages 77 – 78	Sections 10.12 – 10.19	Imposed Conditions, Proportionality, Duplication with other statutory provisions
Page 78	Sections 10.20 – 10.22	Hours of Trading
Pages 8 – 11	Sections 2.1 – 2.16	Crime & Disorder
Pages 15 – 16	Sections 2.33 – 2.40	Public Nuisance

**CHERWELL DISTRICT COUNCIL STATEMENT OF LICENSING POLICY,
JANUARY 2010:**

Page 1	Policy GN1	Sections 1.1.1 – 1.1.2	Objectives
Pages 3 - 4	N/A	Sections 2.5.1 – 2.5.13	Fundamental Principles
Pages 5 - 6	Policy GN8	Sections 2.10.1 – 2.10.2	Planning & Building Control
Page 8	N/A	Sections 2.10.1 – 2.10.2	Non-Licensing Issues
Pages 12-14	Policies LH1 – LH8	Sections 5.1 – 5.7	Licensing Hours
Pages 19-21	Policies LA4 – LA6	Sections 7.3.1 – 7.3.13	General Prevention Of Public Nuisance including Addressing Local Concerns and Management and Control
Pages 32 - 38	Policies OS1 – OS18	Sections 8.1.1 – 8.8.2	Operating Schedules including addressing Crime & Disorder and Public Nuisance

The following options have been identified. The approach in the recommendations is believed to be the best way forward

- Option One** Approve the application for the grant of a premises licence as submitted
- Option Two** Reject the application for the grant of premises licence in whole or part
- Option Three** Place conditions on the grant of premises licence and/or require changes to the details of the permissions sought.

Consultations

The applicant carried out a full consultation in accordance with the requirements of the Licensing Act 2003 for a period of 28 days ending at midnight on 23 October 2012.

Implications

Financial:	There are no financial implications of this report Comments checked by Kate Drinkwater, Service Accountant 01327 322188,
Legal:	The decision must comply with relevant legislation and Council Policy. All parties have a right of Appeal to the Magistrates Court against the decision Comments checked by Paul Manning, Solicitor, 01295 221691
Risk Management:	There is a risk that if policy and legislation has not been correctly followed, any resulting appeal could be successful. Comments checked by Nigel Bell, Planning and Litigation Team Leader, 01295 221687

Wards Affected

Bicester Town Ward

Document Information

Appendix No	Title
1	Application for a premises licence to be granted under the Licensing Act 2003 in respect of the Vue Cinema, Bure Place, Bicester
2	Representation from Hollie Franks of the Trading Standards Service at Oxfordshire County Council
3	Representation from Steve Briggs of Oxfordshire County Council Fire and Rescue Service
4	Representation from Rob Lowther of the Anti Social Behaviour Team at Cherwell District Council
5	Further correspondence from Rob Lowther of the Anti Social Behaviour Team at Cherwell District Council
6	Email from Laura Morris of the Licensing Team at Thames Valley Police
7	Representation from Laura Morris of the Licensing Team at Thames Valley Police
8	Letter from Claire Bold, Licensing Team Leader at Cherwell District Council following meeting held on 16 October 2012.
9	Letters of objection from all 53 Interested Parties, including further correspondence from Mr Clark-Dunn and Councillor Mould.
10	Map showing the location of the Interested Party properties in relation to the premises.
Background Papers	
Members have been issued with copies of the Guidance, the Statement of Licensing Policy and the Council's pool of conditions and are asked to bring them to the meeting.	
Report Author	Claire Bold, Licensing Team Leader
Contact Information	01295 753741 claire.bold@cherwell-dc.gov.uk

This page is intentionally left blank

Cherwell District Council

**Application for a premises licence to be granted
under the Licensing Act 2003**

PLEASE READ THE FOLLOWING INSTRUCTIONS FIRST

Before completing this form please read the guidance notes at the end of the form.
If you are completing this form by hand please write legibly in block capitals. In all cases ensure that your answers are inside the boxes and written in black ink. Use additional sheets if necessary.
You may wish to keep a copy of the completed form for your records.

We Vue Entertainment Limited

apply for a premises licence under section 17 of the Licensing Act 2003 for the premises described in Part 1 below (the premises) and I/we are making this application to you as the relevant licensing authority in accordance with section 12 of the Licensing Act 2003

Part 1 – Premises Details

Postal address of premises or, if none, ordnance survey map reference or description			
Vue Cinema			
Bure Place			
Post town	Bicester	Post code	OX26 6FA

Telephone number at premises (if any)	
Non-domestic rateable value of premises	£ NOT YET DETERMINED

Part 2 - Applicant Details

Please state whether you are applying for a premises licence as
Please tick yes

- a) an individual or individuals * please complete section (A)
- b) a person other than an individual *
 - i. as a limited company please complete section (B)
 - ii. as a partnership please complete section (B)
 - iii. as an unincorporated association or please complete section (B)
 - iv. other (for example a statutory corporation) please complete section (B)
- c) a recognised club please complete section (B)
- d) a charity please complete section (B)
- e) the proprietor of an educational establishment please complete section (B)
- f) a health service body please complete section (B)
- g) a person who is registered under Part 2 of the Care Standards Act 2000 (c14) in respect of an independent hospital please complete section (B)
- h) the chief officer of police of a police force in England and Wales please complete section (B)

* If you are applying as a person described in (a) or (b) please confirm:

Please tick yes

- I am carrying on or proposing to carry on a business which involves the use of the premises for licensable activities; or
- I am making the application pursuant to a
 - statutory function or

- o a function discharged by virtue of Her Majesty's prerogative

(A) INDIVIDUAL APPLICANTS (fill in as applicable)

Mr <input type="checkbox"/>	Mrs <input type="checkbox"/>	Miss <input type="checkbox"/>	Ms <input type="checkbox"/>	Other Title (for example, Rev)	
Surname			First names		
I am 18 years old or over					<input type="checkbox"/> Please tick yes
Current postal address if different from premises address					
Post Town				Postcode	
Daytime contact telephone number					
E-mail address (optional)					

SECOND INDIVIDUAL APPLICANT (if applicable)

Mr <input type="checkbox"/>	Mrs <input type="checkbox"/>	Miss <input type="checkbox"/>	Ms <input type="checkbox"/>	Other Title (for example, Rev)	
Surname			First names		
I am 18 years old or over					<input type="checkbox"/> Please tick yes
Current postal address if different from premises address					
Post Town				Postcode	
Daytime contact telephone number					
E-mail address (optional)					

(B) OTHER APPLICANTS

Please provide name and registered address of applicant in full. Where appropriate please give any registered number. In the case of a partnership or other joint venture (other than a body corporate), please give the name and address of each party concerned.

Name	Vue Entertainment Limited
Address	Vue Entertainment 10 Chiswick Park 566 Chiswick High Road London W4 5XS
Registered number (where applicable)	4699504
Description of applicant (for example, partnership, company, unincorporated association etc.)	Limited Company
Telephone number (if any)	0208 396 0100

E-mail address (optional)

Part 3 Operating Schedule

When do you want the premises licence to start?

Day Month Year
A S A P [] [] [] [] [] [] [] []

If you wish the licence to be valid only for a limited period, when do you want it to end?

Day Month Year
[] [] [] [] [] [] [] []

A

Please give a general description of the premises (please read guidance note1)

These premises will operate as a multiplex cinema within a larger mixed use retail and entertainment development. The applicant operates in excess of 70 cinemas throughout England, Wales and Scotland the majority of which are licensed for the sale of alcohol as well as the primary activity of showing films

The sale of alcohol and the provision of other types of regulated entertainment other than the showing of films will be ancillary to the use of the premises as a cinema.

If 5,000 or more people are expected to attend the premises at any one time, please state the number expected to attend.

[]

What licensable activities do you intend to carry on from the premises?
(Please see sections 1 and 14 of the Licensing Act 2003 and Schedules 1 and 2 to the Licensing Act 2003)

Provision of regulated entertainment

Please tick yes

- a) plays (if ticking yes, fill in box A)
- b) films (if ticking yes, fill in box B)
- c) indoor sporting events (if ticking yes, fill in box C)
- d) boxing or wrestling entertainment (if ticking yes, fill in box D)
- e) live music (if ticking yes, fill in box E)
- f) recorded music (if ticking yes, fill in box F)
- g) performances of dance (if ticking yes, fill in box G)
- h) anything of a similar description to that falling within (e), (f) or (g) (if ticking yes, fill in box H)

Provision of entertainment facilities:

- i) making music (if ticking yes, fill in box I)
- j) dancing (if ticking yes, fill in box J)
- k) entertainment of a similar description to that falling within (i) or (j) (if ticking yes, fill in box K)

Provision of late night refreshment (if ticking yes, fill in box L)

Supply of alcohol (if ticking yes, fill in box M)

In all cases complete boxes N, O and P

A

Plays Standard days and timings (please read guidance note 6)			Will the performance of a play take place indoors or outdoors or both – please tick (please read guidance note 2)	Indoors	<input checked="" type="checkbox"/>
				Outdoors	<input type="checkbox"/>
				Both	<input type="checkbox"/>
Day	Start	Finish	Please give further details here (please read guidance note 3) The performances of play		
Mon	0900	0300			
Tue	0900	0300	State any seasonal variations for performing plays (please read guidance note 4)		
Wed	0900	0300			
Thur	0900	0300	Non standard timings. Where you intend to use the premises for the performance of plays at different times to those listed in the column on the left, please list (please read guidance note 5) An additional hour on the day that British Summertime commences.		
Fri	0900	0300			
Sat	0900	0300	From the end of permitted hours on New Year Eve to the start of permitted hours on New Year's Day		
Sun	0900	0300			

B

Films Standard days and timings (please read guidance note 6)			Will the exhibition of films take place indoors or outdoors or both – please tick (please read guidance note 2)	Indoors	<input checked="" type="checkbox"/>
				Outdoors	<input type="checkbox"/>
				Both	<input type="checkbox"/>
Day	Start	Finish	Please give further details here (please read guidance note 3) Including the showing of movies and pop dvds		
Mon	24 hours				
Tue	24 hours		State any seasonal variations for the exhibition of films (please read guidance note 4)		
Wed	24 hours				
Thur	24 hours		Non standard timings. Where you intend to use the premises for the exhibition of films at different times to those listed in the column on the left, please list (please read guidance note 5) An additional hour on the day that British Summertime commences.		
Fri	24 hours				
Sat	24 hours		From the end of permitted hours on New Year Eve to the start of permitted hours on New Year's Day		
Sun	24 hours				

C

Indoor sporting events Standard days and timings (please read guidance note 6)			<p><u>Please give further details</u> (please read guidance note 3)</p> <hr/> <p><u>State any seasonal variations for indoor sporting events</u> (please read guidance note 4)</p> <hr/> <p><u>Non standard timings. Where you intend to use the premises for indoor sporting events at different times to those listed in the column on the left, please list</u> (please read guidance note 5)</p>
Day	Start	Finish	
Mon			
Tue			
Wed			
Thur			
Fri			
Sat			
Sun			

D

Boxing or wrestling entertainments Standard days and timings (please read guidance note 6)			<p><u>Will the boxing or wrestling entertainment take place indoors or outdoors or both – please tick</u> (please read guidance note 2)</p> <table border="1"> <tr> <td>Indoors</td> <td><input checked="" type="checkbox"/></td> </tr> <tr> <td>Outdoors</td> <td><input type="checkbox"/></td> </tr> <tr> <td>Both</td> <td><input type="checkbox"/></td> </tr> </table>	Indoors	<input checked="" type="checkbox"/>	Outdoors	<input type="checkbox"/>	Both	<input type="checkbox"/>
Indoors	<input checked="" type="checkbox"/>								
Outdoors	<input type="checkbox"/>								
Both	<input type="checkbox"/>								
Day	Start	Finish							
Mon									
Tue									
Wed									
Thur									
Fri									
Sat									
Sun									

E

Live music Standard days and timings (please read guidance note 6)			Will the performance of live music take place indoors or outdoors or both – please tick (please read guidance note 2)	Indoors	<input checked="" type="checkbox"/>
				Outdoors	<input type="checkbox"/>
				Both	<input type="checkbox"/>
Day	Start	Finish	Please give further details here (please read guidance note 3)		
Mon	0900	0300	Performance of live amplified and non-amplified music		
Tue	0900	0300			
Wed	0900	0300	State any seasonal variations for the performance of live music (please read guidance note 4)		
Thur	0900	0300			
Fri	0900	0300			
Sat	0900	0300	Non standard timings. Where you intend to use the premises for the performance of live music at different times to those listed in the column on the left, please list (please read guidance note 5) An additional hour on the day that British Summertime commences.		
Sun	0900	0300	From the end of permitted hours on New Year Eve to the start of permitted hours on New Year's Day		

F

Recorded music Standard days and timings (please read guidance note 6)			Will the playing of recorded music take place indoors or outdoors or both – please tick (please read guidance note 2)	Indoors	<input checked="" type="checkbox"/>
				Outdoors	<input type="checkbox"/>
				Both	<input type="checkbox"/>
Day	Start	Finish	Please give further details here (please read guidance note 3)		
Mon	0900	0300	Playing of recorded music through in-house music system		
Tue	0900	0300			
Wed	0900	0300	State any seasonal variations for the playing of recorded music (please read guidance note 4)		
Thur	0900	0300			
Fri	0900	0300			
Sat	0900	0300	Non standard timings. Where you intend to use the premises for the playing of recorded music at different times to those listed in the column on the left, please list (please read guidance note 5) An additional hour on the day that British Summertime commences.		
Sun	0900	0300	From the end of permitted hours on New Year Eve to the start of permitted hours on New Year's Day		

G

Performances of dance Standard days and timings (please read guidance note 6)			Will the performance of dance take place indoors or outdoors or both – please tick (please read guidance note 2)		Indoors	<input checked="" type="checkbox"/>
					Outdoors	<input type="checkbox"/>
					Both	<input type="checkbox"/>
Day	Start	Finish	Please give further details here (please read guidance note 3)			
Mon	0900	0300				
Tue	0900	0300				
Wed	0900	0300	State any seasonal variations for the performance of dance (please read guidance note 4)			
Thur	0900	0300				
Fri	0900	0300	Non standard timings. Where you intend to use the premises for the performance of dance at different times to those listed in the column on the left, please list (please read guidance note 5)			
Sat	0900	0300	An additional hour on the day that British Summertime commences.			
Sun	0900	0300	From the end of permitted hours on New Year Eve to the start of permitted hours on New Year's Day			

H

Anything of a similar description to that falling within (e), (f) or (g) Standard days and timings (please read guidance note 6)			Please give a description of the type of entertainment you will be providing			
Day	Start	Finish				
Mon					Outdoors	<input type="checkbox"/>
					Both	<input type="checkbox"/>
Tue			Please give further details here (please read guidance note 3)			
Wed						
Thur			State any seasonal variations for entertainment of a similar description to that falling within (e), (f) or (g) (please read guidance note 4)			
Fri						
Sat			Non standard timings. Where you intend to use the premises for the entertainment of a similar description to that falling within (e), (f) or (g) at different times to those listed in the column on the left, please list (please read guidance note 5)			
Sun						

I

Provision of facilities for making music Standard days and timings (please read guidance note 6)			<u>Please give a description of the facilities for making music you will be providing</u>	
			<u>Will the facilities for making music be indoors or outdoors or both – please tick</u> (please read guidance note 2)	Indoors <input checked="" type="checkbox"/>
				Outdoors <input type="checkbox"/>
				Both <input type="checkbox"/>
Day	Start	Finish	<u>Please give further details here</u> (please read guidance note 3)	
Mon	0900	0300		
Tue	0900	0300		
Wed	0900	0300	<u>State any seasonal variations for the provision of facilities for making music</u> (please read guidance note 4)	
Thur	0900	0300		
Fri	0900	0300	<u>Non standard timings. Where you intend to use the premises for provision of facilities for making music at different times to those listed in the column on the left, please list</u> (please read guidance note 5)	
Sat	0900	0300	An additional hour on the day that British Summertime commences.	
Sun	0900	0300	From the end of permitted hours on New Year Eve to the start of permitted hours on New Year's Day	

J

Provision of facilities for dancing Standard days and timings (please read guidance note 6)			<u>Will the facilities for dancing be indoors or outdoors or both – please tick</u> (see guidance note 2)	
			Indoors <input checked="" type="checkbox"/>	
			Outdoors <input type="checkbox"/>	
			Both <input type="checkbox"/>	
Day	Start	Finish	<u>Please give a description of the facilities for dancing you will be providing</u>	
Mon	0900	0300	<u>Please give further details here</u> (please read guidance note 3)	
Tue	0900	0300		
Wed	0900	0300	<u>State any seasonal variations for providing dancing facilities</u> (please read guidance note 4)	
Thur	0900	0300		
Fri	0900	0300	<u>Non standard timings. Where you intend to use the premises for the provision of facilities for dancing entertainment at different times to those listed in the column on the left, please list</u> (please read guidance note 5)	
Sat	0900	0300	An additional hour on the day that British Summertime commences.	
Sun	0900	0300	From the end of permitted hours on New Year Eve to the start of permitted hours on New Year's Day	

K

Provision of facilities for entertainment of a similar description to that falling within i or j Standard days and timings (please read guidance note 6)			<u>Please give a description of the type of entertainment facility you will be providing</u>		
Day	Start	Finish	<u>Will the entertainment facility be indoors or outdoors or both – please tick</u> (please read guidance note 2)	Indoors	<input type="checkbox"/>
Mon				Outdoors	<input type="checkbox"/>
				Both	<input type="checkbox"/>
Tue			<u>Please give further details here</u> (please read guidance note 3)		
Wed					
Thur			<u>State any seasonal variations for the provision of facilities for entertainment of a similar description to that falling within i or j</u> (please read guidance note 4)		
Fri					
Sat			<u>Non standard timings. Where you intend to use the premises for the provision of facilities for entertainment of a similar description to that falling within i or j at different times to those listed in the column on the left, please list</u> (please read guidance note 5)		
Sun					

L

Late night refreshment Standard days and timings (please read guidance note 6)			Will the provision of late night refreshment take place indoors or outdoors or both – please tick (please read guidance note 2)		Indoors	<input type="checkbox"/>
Day	Start	Finish			Outdoors	<input type="checkbox"/>
Mon	2300	0500			Both	<input checked="" type="checkbox"/>
Tue	2300	0500	<u>Please give further details here</u> (please read guidance note 3) Provision of hot food and drinks			
Wed	2300	0500	<u>State any seasonal variations for the provision of late night refreshment</u> (please read guidance note 4)			
Thur	2300	0500				
Fri	2300	0500	<u>Non standard timings. Where you intend to use the premises for the provision of late night refreshment at different times, to those listed in the column on the left, please list</u> (please read guidance note 5)			
Sat	2300	0500	An additional hour on the day that British Summertime commences.			
Sun	2300	0500	From the end of permitted hours on New Year Eve to the start of permitted hours on New Year's Day			

M

Supply of alcohol Standard days and timings (please read guidance note 6)			Will the supply of alcohol be for consumption (Please tick box) (please read guidance note 7)	On the premises	<input checked="" type="checkbox"/>
				Off the premises	<input type="checkbox"/>
				Both	<input type="checkbox"/>
Day	Start	Finish	State any seasonal variations for the supply of alcohol (please read guidance note 4)		
Mon	0900	0230			
Tue	0900	0230			
Wed	0900	0230			
Thur	0900	0230			
Fri	0900	0230			
Sat	0900	0230			
Sun	0900	0230			
			Non standard timings. Where you intend to use the premises for the supply of alcohol at different times to those listed in the column on the left, please list (please read guidance note 5)		
			An additional hour on the day that British Summertime commences.		
			From the end of permitted hours on New Year Eve to the start of permitted hours on New Year's Day		

State the name and details of the individual whom you wish to specify on the licence as premises supervisor

Name Jaimini Bhatia	
Address 5 Cotswold Drive Randlay Telford	
Postcode	TF3 2NR
Personal Licence number (if known) BTW/PER 0235	
Issuing licensing authority (if known) Telford and Wrekin Council	

N

Please highlight any adult entertainment or services, activities, other entertainment or matters ancillary to the use of the premises that may give rise to concern in respect of children (please read guidance note 8) NONE

O

Hours premises are open to the public Standard days and timings (please read guidance note 6)			State any seasonal variations (please read guidance note 4)
Day	Start	Finish	
Mon	24 hours		
Tue	24 hours		
Wed	24 hours		
Thur	24 hours		
Fri	24 hours		
Sat	24 hours		
Sun	24 hours		

P Describe the steps you intend to take to promote the four licensing objectives:
a) General – all four licensing objectives (b,c,d,e) (please read guidance note 9)

See below

b) The prevention of crime and disorder

1. Notices stating that CCTV is in operation will be displayed throughout the venue;
2. A tamper proof CCTV system shall be installed, maintained and operated at the premises in liaison with and to the satisfaction of The Metropolitan Constabulary and shall be used to record during all hours the premises are open to the public. *TVP*
3. Sale of alcohol will cease at 02:30 or 30 minutes before the end of the last film showing at the premises whichever is the earlier.
4. Each auditoria is visited by a member of staff during film showings to monitor screens and the behavior of customers. These staff are issued with night vision goggles or equivalent.

c) Public safety

1. The occupancy capacity of the premises shall be identified by way of Risk Assessment;
2. All staff shall receive training in emergency evacuation procedures

d) The prevention of public nuisance

1. Considering the nature and location of the premises it is not considered that any steps are required to promote this licensing objective

e) The protection of children from harm

1. The premises shall operate a proof of age scheme and Challenge 21 policy. Notices setting out this policy shall be displayed within the premises.
2. All staff involved in the sale of alcohol shall be properly trained (as per the premise licence holder's own training programme) and retrained every 6 months.

Please tick yes

- I have made or enclosed payment of the fee



- I have enclosed the plan of the premises
- I have sent copies of this application and the plan to responsible authorities and others where applicable
- I have enclosed the consent form completed by the individual I wish to be premises supervisor, if applicable
- I understand that I must now advertise my application
- I understand that if I do not comply with the above requirements my application will be rejected

IT IS AN OFFENCE, LIABLE ON CONVICTION TO A FINE UP TO LEVEL 5 ON THE STANDARD SCALE, UNDER SECTION 158 OF THE LICENSING ACT 2003 TO MAKE A FALSE STATEMENT IN OR IN CONNECTION WITH THIS APPLICATION

Part 4 – Signatures (please read guidance note 10)

Signature of applicant or applicant’s solicitor or other duly authorised agent (See guidance note 11). **If signing on behalf of the applicant please state in what capacity.**

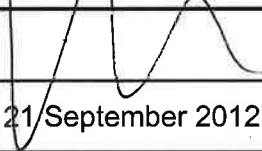
Signature	
Date	21/September 2012
Capacity	Poppleston Allen – Solicitors for and on behalf of the applicant

For joint applications signature of 2nd applicant or 2nd applicant’s solicitor or other authorised agent. (please read guidance note 12). **If signing on behalf of the applicant please state in what capacity.**

Signature	
Date	
Capacity	

Contact name (where not previously given) and postal address for correspondence associated with this application (please read guidance note 13)			
Angela Gardner 37 Stoney Street The Lace Market			
Post town	Nottingham	Post code	NG1 1LS
Telephone number (if any)	0115 9349 157		
If you would prefer us to correspond with you by e-mail your e-mail address (optional)			
a.gardner@popall.co.uk			

Notes for Guidance

1. Describe the premises. For example the type of premises, its general situation and layout and any other information which could be relevant to the licensing objectives. Where your application includes off-supplies of alcohol and you intend to provide a place for consumption of these off-supplies you must include a description of where the place will be and its proximity to the premises.

2. Where taking place in a building or other structure please tick as appropriate. Indoors may include a tent.
3. For example the type of activity to be authorised, if not already stated, and give relevant further details, for example (but not exclusively) whether or not music will be amplified or unamplified.
4. For example (but not exclusively), where the activity will occur on additional days during the summer months.
5. For example (but not exclusively), where you wish the activity to go on longer on a particular day e.g. Christmas Eve.
6. Please give timings in 24 hour clock (e.g. 16:00) and only give details for the days of the week when you intend the premises to be used for the activity.
7. If you wish people to be able to consume alcohol on the premises please tick on, if you wish people to be able to purchase alcohol to consume away from the premises please tick off. If you wish people to be able to do both please tick both.
8. Please give information about anything intended to occur at the premises or ancillary to the use of the premises which may give rise to concern in respect of children, regardless of whether you intend children to have access to the premises, for example (but not exclusively) nudity or semi-nudity, films for restricted age groups, the presence of gaming machines.
9. Please list here steps you will take to promote all four licensing objectives together.
10. The application form must be signed.
11. An applicant's agent (for example solicitor) may sign the form on their behalf provided that they have actual authority to do so.
12. Where there is more than one applicant, both applicants or their respective agents must sign the application form.
13. This is the address which we shall use to correspond with you about this application.

**CONSENT OF INDIVIDUAL TO BEING SPECIFIED AS
PREMISES SUPERVISOR**

To be completed in block capitals

I Mrs Jaimini Bhatia of 5 Cotswold Drive, Randlay, Telford, TF3 2NR hereby confirm that I give my consent to be specified as the Designated Premises Supervisor in relation to the application for a New Premises Licence by Vue Entertainment Limited relating to a Premises Licence for Vue Cinema, Bure Place, Bicester, OX26 6FA and any premises licence to be granted or varied in respect of this application made by Vue Entertainment Limited concerning the supply of alcohol at Vue Cinema, Bure Place, Bicester, OX26 6FA

I also confirm that I hold a personal licence, details of which I set out below:

Personal Licence Number:-

BTW/PER 0235

Personal Licence Issuing Authority:-

Telford and Wrekin Council

Signed



Name Printed

JAIMINI BHATIA

Dated

21.09.12

1. Approved by Council
2. Approved by Council

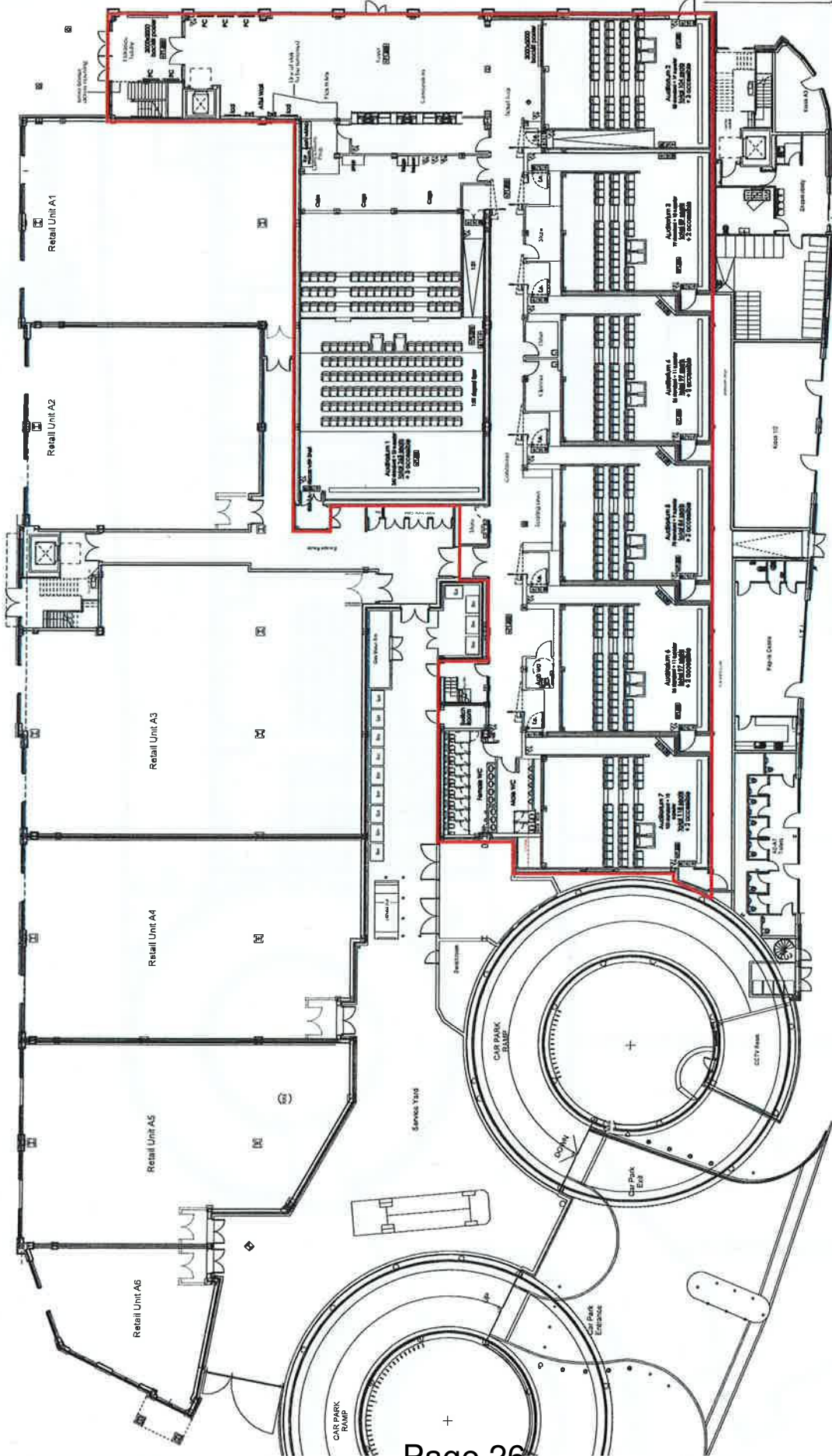

REVISIONS

LICENCE

USE CHSMA
REGISTER
LICENCE IN A OUT
FOYER LEVEL
4220 : LIC01

DATE	NO.	DESCRIPTION
10/10/12	1	ISSUED

UNYK
UNYK ARCHITECTS LIMITED
200/201 WILSON STREET
MELBOURNE VIC 3008
TEL: 03 9412 1000
WWW.UNYKARCHITECTS.COM

AREA FOR PROMOTION OF
LICENSEABLE ACTIVITY

LEGEND

1. AREA FOR PROMOTION OF LICENSEABLE ACTIVITY

2. AREA FOR PROMOTION OF LICENSEABLE ACTIVITY

Symbol	Description
Red Outline	Area for Promotion of Licenseable Activity
Blue Outline	Area for Promotion of Licenseable Activity
Green Outline	Area for Promotion of Licenseable Activity
Yellow Outline	Area for Promotion of Licenseable Activity
Pink Outline	Area for Promotion of Licenseable Activity

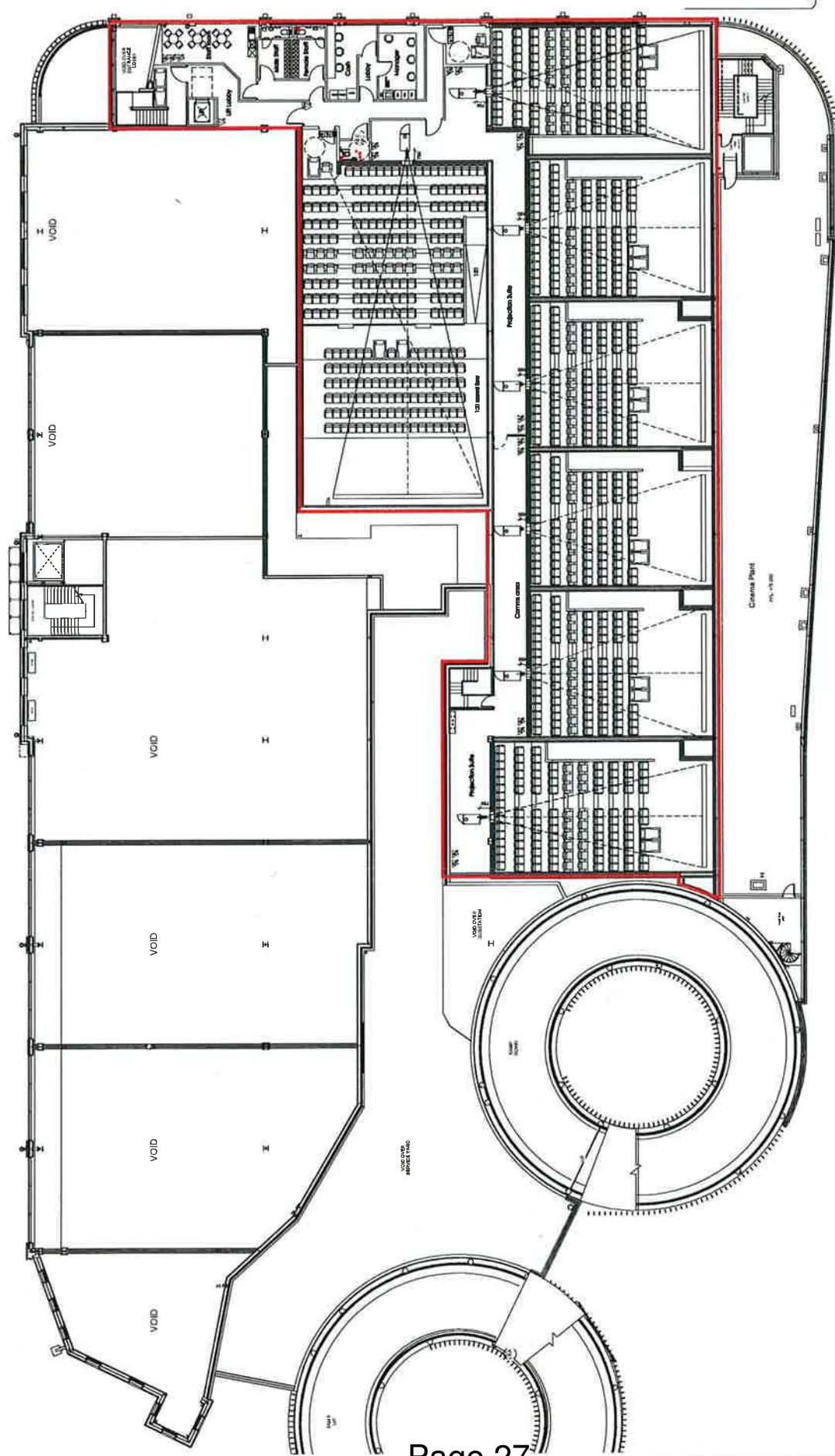

LICENCE

VUE CINEMA
 BICESTER
 LICENCE LAYOUE
 PROJECTIONNELE
 4220 - LIC02

REVISED: 13/02/2018
 DATE: 13/02/2018
 BY: [Name]

UNIVERSITY OF BIRMINGHAM
 THE COLLEGE OF ARTS
 100 BANK STREET
 BIRMINGHAM B3 7ST

AREA FOR PROVISION OF LICENSABLE ACTIVITY

LEGEND

PORTABLE FIRE FIGHTING EQUIPMENT

1	100% of the area
2	50% of the area
3	25% of the area
4	10% of the area
5	5% of the area
6	2.5% of the area
7	1.25% of the area
8	0.625% of the area
9	0.3125% of the area
10	0.15625% of the area

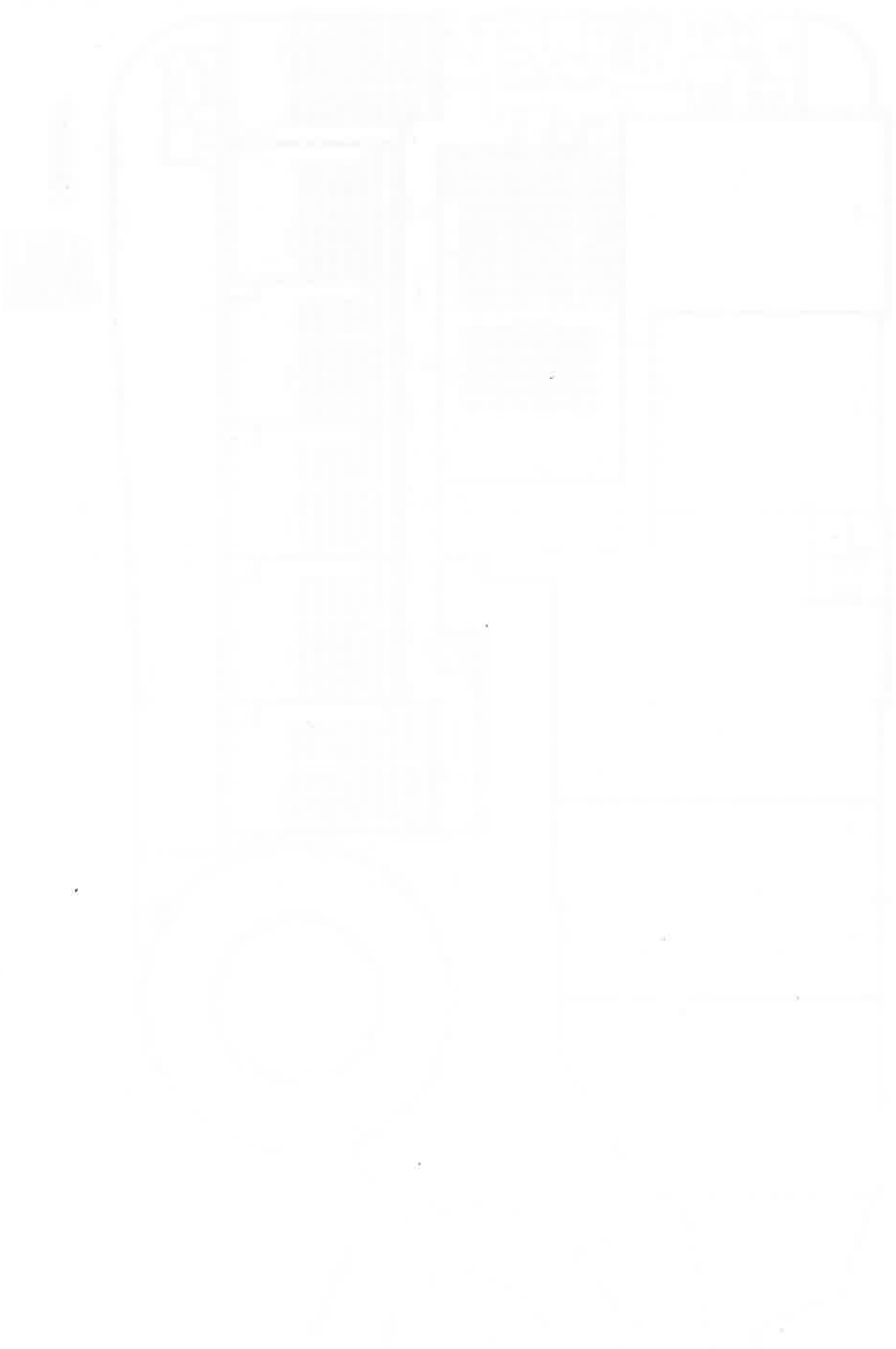

Stacey Walsham

From: Franks, Hollie - Community Safety - Trading Standards [Hollie.Franks@Oxfordshire.gov.uk]
Sent: 24 September 2012 14:44
To: Licensing
Subject: Licensing Application - No Objections
Ref: Vue Cinema, Bure Place, Bicester, OX26 6FA- No Objections

Regards

Hollie Franks

Licensing & Legal Process Clerk

Trading Standards Service
Community Safety & Shared Services
Oxfordshire County Council
Graham Hill House
Electric Avenue
Ferry Hinksey Road
Oxford OX2 0BY
Tel: 01865 810801
www.oxfordshire.gov.uk

 **Please consider the environment before printing this email**

This email, including attachments, may contain confidential information. If you have received it in error, please notify the sender by reply and delete it immediately. Views expressed by the sender may not be those of Oxfordshire County Council. Council emails are subject to the Freedom of Information Act 2000. <http://www.oxfordshire.gov.uk/emaildisclaimer>

This page is intentionally left blank



Oxfordshire County Council
Fire and Rescue Service
West Cherwell Area Office
Cope Road
Banbury
Oxon OX16 2EY

For Attention of: Angela Gardner
Popleston Allen
37 Stoney Street
The Lace Market
Nottingham
NG1 1LS



Telephone: 01295 759 030
Fax: 01295 275 451

Pete Graham
Fire Risk Manager - West Cherwell

My Reference
609/703/012/SB/JH

Your Reference
AG/AG/P41582-647

Date
9 October 12

This matter is being dealt with by Steve Briggs

Direct Line 01869 324 606

Email: stephen.briggs@oxfordshire.gov.uk

Dear Madam

**Licensing Act 2003
No adverse comments from Fire Authority**

Name of Applicant	Vue Entertainment Limited
Premises / Location	Vue Cinema, Bure Place, Bicester
Type of Licence	Application for Premises License

Based upon the information you have provided in connection with your application for a premises licence for the above named premises, and on the understanding that a full risk assessment (see paragraph below) will be /has been undertaken and any necessary actions carried out to resolve any identified shortcomings, **it is confirmed that the Oxfordshire Fire and Rescue Service have no adverse comments to make.**

In the meantime you are reminded that it is your responsibility to ensure an adequate degree of fire safety in your premises to ensure appropriate and reasonable levels of public safety.

Your attention is drawn to the legal requirement contained in the Regulatory Reform (Fire Safety) Order 2005 (see note overleaf) for the responsible person to make a suitable and sufficient assessment of the risks to which relevant persons are exposed Should you wish to discuss this matter, please do not hesitate to contact the Officer indicated.

Yours faithfully

J. Hughes
pp Community Fire Safety Officer

cc: Claire Bold Cherwell District Council Licensing Committee Bodicote House Banbury Oxon



INVESTOR IN PEOPLE



The Regulatory Reform (Fire Safety) Order 2005 (FSO)

The FSO places the responsibility for ensuring the safety of people using the premises firmly upon the employer or the person having control of the premises; the "Responsible Person". The main duty of the "Responsible Person" is to carry out a risk assessment, and to assist them a series of guides have been produced. These give detailed information on risk assessments and other issues and can be downloaded free of charge from the Department for Communities and Local Government website:

<http://www.communities.gov.uk>

You are most strongly advised to obtain the guide for your particular type of premises and to use its guidance to complete your risk assessment.

The Department for Communities and Local Government has setup a website where, amongst other areas of assistance, your risk assessment can be submitted for consideration:

<http://www.fire.gov.uk/>

An overview of the changes that have been brought about by the introduction of the FSO

The Regulatory Reform (Fire Safety) Order 2005 (FSO) became law on 1 October 2006. The main effect of the changes are a move towards greater emphasis on fire prevention in all non-domestic premises, including the voluntary sector and self-employed people with premises separate from their homes.

Fire certificates were abolished and cease to have legal status.

The Fire Safety Order applies in England and Wales. It covers 'general fire precautions' and other fire safety duties which are needed to protect 'relevant persons' in case of fire in and around most 'premises'. The Order requires fire precautions to be put in place "where necessary" and to the extent that it is reasonable and practicable in the circumstances of the case.

Responsibility for complying with the Fire Safety Order rests with the 'responsible person'. In a workplace, this is the employer and any other person who may have control of any part of the premises, e.g. the occupier or owner. In all other premises, the person or people in control of the premises will be responsible. If there is more than one responsible person in any type of premises, all must take every reasonable step to work with each other.

If you are the responsible person, you have to carry out a fire risk assessment which must focus on the safety in case of fire of all 'relevant persons'. It should pay particular attention to those at special risk, such as the disabled and those with special needs, and must include consideration of any dangerous substance likely to be on the premises.

Your fire risk assessment will help you identify risks that can be removed or reduced and to decide the nature and extent of the general fire precautions you need to take to protect people against the fire risks that remain.

Further guidance concerning licensed premises may also be found in the "Guidance issued under section 182 of the Licensing Act 2003" issued by the Department for Culture, Media and Sport.

**Cherwell District Council
Public Protection and Development Management
Anti-Social Behaviour Units Licensing Consultation Response.**

**Licensing Act 2003: Application for a premises license
Applicant(s): Poppleston Allen, Solicitors on behalf of Vue Entertainments Limited
10 Chiswick Park 566 Chiswick High Road London W4 5XS**

Premises:

Vue Cinema Bure Place Bicester Oxon

Details of the application:

An application for a premises license in respect of a multiplex cinema for the following licensable activities:

- The supply of alcohol for consumption on the premises between the hours of 09:00 and 02:30 seven days per week.
- The provision of regulated entertainment including the performance of plays, the screening of films, the provision of live music, the provision of recorded music, the performance of dance, the provision of facilities for making music, provision of facilities for dancing between the hours of 09:00 and 03:00 seven days per week.
- The provision of late night refreshment between the hours of 23:00 and 05:00 seven days per week.

History

As this application relates to new premises there is no relevant history relating to public nuisance.

Observations.

I have no observations to make in respect of this application

Recommendation.

That a Premises License be granted as per Poppleston Allens' application dated 21st September 2012

**Rob Lowther
Anti Social Behaviour Manager
26/09/12**

This page is intentionally left blank

Claire Bold

From: Rob Lowther
Sent: 24 October 2012 09:34
To: Claire Bold
Subject: V1.2

Follow Up Flag: Follow up
Flag Status: Red

Claire

In response to point 2 as the Responsible Authority for Public Nuisance we are not obliged to consult with those who may choose to object to a particular license application or indeed to represent their views. Our role is to make a balanced professional judgement as to the likely impact of a given application.

Moving on in my view the profile of a cinema audience is quite different to the profile of those individuals who may visit the town centre to consume alcohol and to visit the late night drinking establishments. For the record these people generally attend cinemas as couples, or in family or friendship groups. People fitting these profiles are not generally associated with crime and disorder.

The sale of alcohol at the venue seems to have heightened residents concerns. I too was concerned when the application was initially received but having made enquiries of the applicants solicitors Poppleston Allen and discovered the way in which alcohol is to be provided my concerns were unfounded. Alcohol is to be provided only to customers holding a ticket for a cinema performance. Sales are to be restricted by a time frame prior to the performance. In this way strict control over individual customers consumption and behaviour following consumption is possible.

Having made enquiries in relation to other Vue operations crime and disorder from customers leaving the premises is a significantly less likely occurrence than from other styles of entertainment venues opening similar hours.

Trying to predict the movement of customers from premises whose surroundings are not yet established must be pure speculation. However bearing in mind that cinema customers will arrive at the venue from all four points of the compass it is reasonable to assume that they will disperse in a similar fashion

Rob Lowther

ASB Manager

This page is intentionally left blank

Stacey Walsham

From: Angie Gardner [A.Gardner@popall.co.uk]
Sent: 24 September 2012 12:11
To: Morris Laura
Cc: Licensing
Subject: RE: Vue Cinema Bicester

My apologies Laura, I am getting my Police units all mixed up, yes it should refer to Thames Valley Police.

Many thanks

Angie Gardner
Para-Legal - Poppleston Allen
T : 0115 934 9157 M : 07967 642424 W : www.popall.co.uk

From: Morris Laura [mailto:Laura.Morris@thamesvalley.pnn.police.uk]
Sent: 24 September 2012 12:07
To: Angie Gardner
Cc: licensing@cherwell-dc.gov.uk
Subject: Vue Cinema Bicester

Hello

Initial response to application is that on section P (steps to promote licensing objectives) i would need point 2 to be reworded to state Thames Valley police not Metropolitan Constabulary.

Further response will follow once inspector has looked at the application.

Regards

Laura Morris | Oxfordshire Licensing Officer | Telephone : 01865 846 150 | Internal: 700 6150 |
Mobile: 07989 497913
Address: Licensing, Thames Valley Police, HQ South, Oxford Rd, Kidlington, OX5 2NX
For information, guidance and the Licensing Toolkit, visit: <http://knowzone/kz-lic-homepage.htm>

Thames Valley Police Currently use the Microsoft Office 2002 suite of applications. Please be aware of this if you intend to include an attachment with your email. This communication contains information which is confidential and may also be privileged. Any views or opinions expressed are those of the originator and not necessarily those of Thames Valley Police. It is for the exclusive use of the addressee(s). If you are not the intended recipient(s) please note that any form of distribution, copying or use of this communication or the information in it is strictly prohibited and may be unlawful. If you have received this communication in error please forward a copy to: informationsecurity@thamesvalley.pnn.police.uk and to the sender. Please then delete the e-mail and destroy any copies of it. Thank you.

Nottingham Office : 37 Stoney Street, The Lace Market, Nottingham, NG1 1LS T : 0115 953 8500 F : 0115 953 8501

Authorised and Regulated by the Solicitors Regulation Authority (SRA No: 78244). The professional rules to which we are subject are the Solicitors Code of Conduct. These rules can be viewed at www.sra.org.uk.

This email and the attachments are intended for the above named persons only and may be confidential and privileged. If you receive it in error please tell the sender immediately and do not copy, show or distribute them to anyone. Although we have taken steps to ensure that this email and its attachments are free from any viruses, it is your responsibility to ensure that viruses do not adversely affect your system.

Shaded sections, where possible, to be completed **BEFORE** being allocated to the individual undertaking the assessment. The rest to be completed by the officer undertaking the assessment. Attach AL 3 to the application form.



THAMES VALLEY POLICE

To be completed **BEFORE** :

Triage Categorisation
A/B/C

Premise Licence Application, Police Response

Name of premises		Address And phone number(s)	Name of applicant (individual or company)	Company name if different to applicant
Vue Cinema		Bure Place Bicester		
Date application received & allocated to officer		TVP licensing officer dealing with application	Licensing Authority dealing with application	Type of Application
Received	24/9/12	LM	CDC	Variation* *delete as appropriate
Allocated				

Applicants correspondence address if different to premises	Date assessment process began	Date(s) contact made between licensing and applicant or other:		Other person acting on behalf of applicant
		Date	Persons	
	Date Responded 25/9/12			

Application details: cinema 24hr opening and film and late night refreshment , 09.00 – 03.00 regulated entertainment, alcohol 09.00 – 02.30.

Licensing officer comments: no concerns this is the same as other vue licences that are in the TVP area.

Officer Comments: no concerns

Thames Valley Police are satisfied with this application and do not wish to make a representation

This page is intentionally left blank

Public Protection & Development Management

Andy Preston – Head of Public Protection & Development Management



DISTRICT COUNCIL
NORTH OXFORDSHIRE

«IP_Name»
«IP_Address_1»
«IP_Address_2»
«IP_Address_3»
«IP_Address_4»
«IP_Address_5»
«IP_Address_6» «IP_Address_7»

Bodicote House
Bodicote
Banbury
Oxfordshire
OX15 4AA
www.cherwell.gov.uk

Please ask for: Claire Bold

Direct Dial: 01295 753741

Email: claire.bold@cherwell-dc.gov.uk

Our Ref: PRM0631_NEW_APP

17 October 2012

Dear «IP_Name»,

Application for a Premises Licence: Vue Cinema, Bure Place, Bicester

On 16 October 2012, a meeting was held for local residents who had expressed written concerns over the premises licence application for Vue Cinemas, Bure Place, Bicester to meet with Mr Kam Dosanjh, Operations Manager for Vue Cinema.

During the course of the meeting, a number of concerns were expressed by the residents in relation to the application, namely:

- The noise nuisance that may be caused by people leaving the cinema in the early hours of the morning and the associated traffic noise
- Issues surrounding parking at the Cinema including how much it will cost, and whether people will be encouraged to use the car park provided to prevent them from parking on road
- The location of the 'Vue' illuminated sign on the premises and the times this may be in use and the impact it may have upon local houses
- The sales of alcohol and how these will be managed
- The number of times the premises will be open beyond midnight for late night screenings

Mr Dosanjh explained the sound proofing systems in the building and also the nature of the cinema, which will be classed as a 'Vue Light' and hold a maximum of 751 seats throughout the seven screens, incorporating 102 VIP seats. Mr Dosanjh also explained that no alcohol will be sold to any person who does not hold a valid cinema ticket and that alcohol sales will cease half an hour before the end of the last cinema screening, or at 2.30am, whichever is the latest.

As a result of the meeting, all the concerns raised by residents have been forwarded to the applicant's solicitor for their consideration. The Licensing Authority will continue to collate all written objections to the application prior to midnight on 23 October 2012. A tentative date for a hearing to determine the application has been set for 19 November 2012. Full details of the hearing and the procedures to be followed will be sent to all parties after the end of the consultation period.

Cont...

The concerns raised at the meeting, along with others, are expressed in the written letters of objection that have been received by the Licensing Team. The list above is not an exhaustive list. Your full letter of objection will be included in the documentation for the hearing for the consideration of the Licensing Sub Committee.

Please note, some concerns raised at the meeting are unable to be addressed by the Licensing Team. These concerns are being passed to the relevant teams at Cherwell District Council and Oxfordshire County Council, respectively.

If you have any queries regarding this application or the processes involved in making and determining an application, please do not hesitate to contact a member of the Licensing Team on 01295 753744.

Yours sincerely

Claire Bold
Licensing Team Leader

22 Hunt Cross
Bicester
OXON
OX26 6HX
01869 247093
07970 187557



Ref
New Cinema
Application

Dear Sirs,

As you can see I live in Hunt Cross and I feel not enough consideration has been given to the residents at Harrow Gardens. I understand nearly 100 people reside there and with the extra noise created by the late bus and traffic at all hours of the night, I do feel the application for a 24 hour cinema and the late drinking licence should be refused. I cannot believe the council can even be considering 5 AM licenses, its unfair on these residents and should be dismissed accordingly.

Yours Faithfully
John T. Bailey



Mr R Danzey
26, Hanover Gardens
Bicester,
Oxon,
OX26 6DG.

10-10-2012



Dear Sir/Madam,

I am writing to lodge an objection to the Licences applied for by VUE CINEMA, Bure Place, Bicester.

When I moved into my flat I was aware there would be a Sainsbury's Supermarket-a Cinema and various shops with a car park on top.....I never thought the Cinema would be applying for Licences to have excessive drinking hours, a Restaurant ,Night club and various other entertainment outlets...

Can you realize the sub standard of living that residents in this area will have to live with – with the coming and going of revellers at all hours of the Day and Night...

Surely these hours would be a breach of the Enviramental Noise act...

Please do NOT grant these Licences as I have just settled down to my retirement and do not feel I could live with all the commotion it would cause with people in and out of that premises 24 hours a day....

Regards

R Danzey

17th Oct 2012



Mr. Ray Danzey
26, Hanover Gardens
Bicester Oxon.
OX26 6DG

Re:- Objection to the Issuing of Certain Licences to View Cinema, Bure Place, Bicester.

Sir/Madam,

I was in attendance at the meeting of local residents and the representative of Vue Cinema.

I would first like to say that 80% of what the gentleman said seemed to me as all he was trying to do was to sell us all the everyday running and sales of the actual business..

I thought we were there to discuss why they need licences for all hours of the day and night. After all we are talking about a Cinema...I was not impressed for one minute the answers he was giving and felt he was only there for the well being of his company, not for the residents who have to live so close to this premises.

I would like to say I still object to the licence applications and feel that the local residents standard of living will be greatly reduced.

May I suggest that the premises be licenced as a cinema only....with the view to just showing films...and that the premises be completely closed by Midnight 7 days a week....

Yours Sincerely

A handwritten signature in black ink, appearing to read "Ray Danzey". The signature is stylized with a large, sweeping initial "R" and a long horizontal stroke extending to the right.

Mr Ray Danzey.

P.S PLEASE NOTE MY NAME IS RAY DANZEY.
NOT ROBERT AS STATED ON YOUR LAST COMMUNICATION.

Claire Bold

From: JOHN LEVERTON [john.leverton@btopenworld.com]
Sent: 08 October 2012 09:08
To: Licensing
Subject: Vue Cinema, Bure Place, Bicester – Application for Premises Licence

Licensing Team Leader
Public Protection and Development Management
Cherwell District Council
Bodicote House
Bodicote
Banbury OX15 4AA

Licensing Act 2003, Section 17
Vue Cinema, Bure Place, Bicester – Application for Premises Licence

We wish formally to object to the above application. The licence if granted in the terms applied for would permit, on any or all 7 days a week:

- Live performances, music and dancing until 3am;
- Alcohol sales until 2.30am;
- Continuous film showings 24 hours a day;
- Late night refreshments until 5am.

These proposals would generate significant activity in the town centre throughout the night and, in particular, a high level of vehicle movements into and out of the car park above the cinema and along Manorsfield Road. This would impact seriously on the amenities of nearby residents, especially in Hanover Gardens, Hunt Close and St John's Street.

We are also apprehensive about the risk of attendant anti-social behaviour throughout the town centre and an increased need for police presence.

We are of the view that for these activities to be carried on during the quiet hours will amount to a public nuisance. We note that under its Statement of Licensing Policy the prevention of such nuisance is an objective to which the District Council is committed in exercising its licensing functions.

We urge that no licence be granted that would enable activities to continue after 11pm, accepting that on Fridays and Saturdays it would be reasonable to extend this to 12 midnight.

Yours

John and Susan Leverton

Mr & Mrs J C D Leverton, 2 Hunt Close, Bicester OX26 6HX
01869 243564

18 Hunt Close
Bicester
Oxon
OX26 6HX
01869 241031

Licensing Department
Cherwell District Council
Bodicote House
Bodicote
Banbury
OX15 4AA



left telephone
message
12-10
mailed
& posted
invite

11 Oct 2010

Dear Sir or Madam

Vue Cinema Bure Place Bicester OX26 6FA Licence Application

We would support refusal of the requested licensing hours for the following reasons:-

- The current town centre development should not have received planning permission because of its close proximity to existing domestic and retirement dwellings besides the total lack of a proper infrastructure to support such a complex.
- 24/7 operations totally flaunt any green policies.
- Extensive hours will bring about additional noise and light pollution.
- Increased traffic and atmospheric pollution.
- Increased burden on police authority and Environmental Health dealing with what will be increased complaints from residential owners.
- Increased incidences of drunken behaviour which other major Cities are already trying to tackle and an issue which current licensing and planning authorities should be legislating or deciding against as stated in the Act. The Act is based upon promotion of the following four licensing objectives:
 1. the prevention of crime and disorder
 2. the prevention of public nuisance
 3. public safety
 4. the protection of children from harm.
- Increased public transport opposite domestic dwellings.
- Approval of such hours would require an application to the European Court in respect of Human Rights of existing residents.

Yours faithfully

A handwritten signature in black ink, appearing to be "S & P V Clark-Dunn".

S & P V Clark-Dunn

Mr Stuart Clark-Dunn
Mrs Paula Valerie.

Claire Bold

From: Stuart Clark-Dunn [spaclarkdunn@gmail.com]
Sent: 23 October 2012 11:41
To: Claire Bold
Cc: john,leverton; libby.griffin@hanover.org.uk; Keith,uney; smcgregor@nqo.com
Subject: Bicester Town Centre Vue Licence application

Claire

Bicester Town Centre Vue Licence

Thanks for your letter although the salient points are included the issue is much wider. The development and subsequent licence whether it be for the Cinema or others has major consequences on those residing and owning properties so close to this architecturally lacking eyesore!

The provision of a licence will increase the level of traffic and general public within the area and more importantly beyond midnight and no matter what others say these are the foundations for noise and nuisance. Even the other evening local revellers dumped take away rubbish on the grass verges.

The outcome of the licence decision will no doubt have an effect on the value of our properties.

The whole development and subsequent operation of the building will affect local residents more importantly both mentally and physically for the rest of their lives whether it will be via increased noise and local activity or disturbed nights.

The original development as being constructed would have favoured the location of the Cinema closer to Sheep Street side thus reducing impact on residential properties. The fact the bus station was confirmed directly opposite residential dwellings is absurd and ill conceived by those designing and approving and shows little if any consideration for those ultimately affected by the project. Currently we are unaware of bus timetables but have asked that standing buses turn off their engines.

The Council parties deciding for or against the licence are not directly affected by their decision and we the residents do not have the financial capacity to fight an appeal on similar terms. More importantly we are financing these decisions through our taxes, this is very galling!

Traffic signals are to be audible where public crossings are installed and will cause noise throughout day and night a matter which is totally unacceptable and has been raised with developers and County Council.

The parking issue manifests itself in many ways but more importantly on occasions prevent us accessing our properties or traffic being parked in locations that form a hazard on a road which has no pavement.

The approval of such a licence and any contraventions of the law by the general public certainly during the night will not be dealt with as from my recollection there are no Police on the streets. The local police station is part manned only during the day.

There are a number of occasions when we are disturbed by the police helicopter and sirens throughout the night.

Another major issue is light pollution currently all the site temporary lights are left on through the night unnecessarily. Ultimately there is concern as to what final light emissions will be as they will ultimately affect residents during the night.

As residents we are constantly bombarded with reasons to be green little regard appears to have been given to this public town centre warehouse! No doubt extensive new lighting and open door policy with regard to space heating will prevail as per Bicester Village. The burden for green policy always appears to be borne by the domestic resident.

The approval of such a licence will increase the activity in the area around the Town any disturbances put a burden on local residents to report in order that they can achieve an undisturbed night or day. This increased burden is unacceptable and morally wrong.

We are currently experiencing the continuous noise from the construction site sometimes as early as 6.00am through to after 6.00pm and more recently on both Saturday and Sunday. The level of noise will continue once the development is in operation. I have written to T Baldry about possible reduction both now and in the future of the Council Tax as compensation, I understand he referred it to the Chief Executive but alas nothing has happened.

If a licence is granted there should be a condition requiring Vue to allow a number of local public events such as theatre dance operatic etc as currently there are no adequate venues for such events.

No doubt this development and its potential ongoing problems re operational hours, noise, traffic pollution and stress may force long standing residents to incur unbudgeted cost of relocating! Is this democratic or morally acceptable? Perhaps the only outcome may be to pursue the issue through the Human Rights Court.

I trust you will take these points into consideration when deciding the licence.

Regards

Stuart and Paula Clark-Dunn

1 Hunt Close
Bicester
Oxon
OX26 6HX

Licensing Team Leader
Public Protection and Development Manager
Cherwell District Council
Bodicote
Banbury OX15 4AA

11 October 2012

Dear Sir/Madam

**Licensing Act 2003, Section 17
Vue Cinema, Bure Place, Bicester – Application for Premises Licence**

We wish to formally object to the above application. The licence if granted in the terms applied for would permit, on any or all 7 days a week:

- Live performances, music and dancing until 03:00am
- Alcohol sales until 02:30am
- Continuous film showings 24 hours a day
- Late night refreshments until 05:00am

These proposals would generate significant activity in the town centre throughout the night and in particular a high level of vehicle movements into and out of the car park above the cinema and along Manorsfield Road. This would impact seriously on the amenities of nearby residents, especially in Hanover Gardens, Hunt Close and St John's Street.

We are also very concerned about the risk of attendant anti-social behaviour and the need for an increased police presence.

It is our opinion that for these activities to be carried out during the quiet hours it will be a public nuisance. We note that under its Statement of Licensing Policy the prevention of such nuisance is an objective to which the District Council is committed in exercising its licensing functions.

We request that no licence be granted that would enable activities to continue after 11:00pm with exception to Fridays and Saturdays where an extension to 12:00 midnight would be feasible.

Yours faithfully

Keith Uney
1 Hunt Close, Bicester

Sarah Atkins
1 Hunt Close, Bicester

Claire Bold

From: KeithEricAllen@aol.com
Sent: 15 October 2012 09:12
To: Licensing
Subject: New Cinema - Late Opening
Attachments: NoticeofapplicationSept2012.doc

I wish to add my strong support per the email below sent by Mr & Mrs J C D Leverton of 2 Hunt Close
 I could not put the case any better.

My name is Mr K E Allen 14 Hunt Close Bicester OX26 6HX Tel No 01869 243170

From: JOHN LEVERTON <john.leverton@btopenworld.com>
To: "licensing@cherwell-dc.gov.uk" <licensing@cherwell-dc.gov.uk>
Sent: Monday, 8 October 2012, 9:08
Subject: Vue Cinema, Bure Place, Bicester – Application for Premises Licence

Licensing Team Leader
 Public Protection and Development Management
 Cherwell District Council
 Bodicote House
 Bodicote
 Banbury OX15 4AA

Licensing Act 2003, Section 17
Vue Cinema, Bure Place, Bicester – Application for Premises Licence

We wish formally to object to the above application. The licence if granted in the terms applied for would permit, on any or all 7 days a week:

- Live performances, music and dancing until 3am;
- Alcohol sales until 2.30am;
- Continuous film showings 24 hours a day;
- Late night refreshments until 5am.

These proposals would generate significant activity in the town centre throughout the night and, in particular, a high level of vehicle movements into and out of the car park above the cinema and along Manorsfield Road. This would impact seriously on the amenities of nearby residents, especially in Hanover Gardens, Hunt Close and St John's Street.

We are also apprehensive about the risk of attendant anti-social behaviour throughout the town centre and an increased need for police presence.

We are of the view that for these activities to be carried on during the quiet hours will amount to a public nuisance. We note that under its Statement of Licensing Policy the prevention of such nuisance is an objective to which the District Council is committed in exercising its licensing functions.

We urge that no licence be granted that would enable activities to continue after 11pm, accepting that on Fridays and Saturdays it would be reasonable to extend this to 12 midnight.

Yours

John and Susan Leverton

Mr & Mrs J C D Leverton, 2 Hunt Close, Bicester OX26 6HX
01869 243564

Claire Bold

From: MOULD RICHARD [richard.mould51@ntlworld.com]

Sent: 11 October 2012 14:45

To: Licensing

Subject: Application for licence for Vue Cinema Bure Place Bicester

Licensing Team Leader
Public Protection and Development Management
Cherwell District Council
Bodicote House
Bodicote
Banbury OX15 4AA

Licensing Act 2003, Section 17

Vue Cinema, Bure Place, Bicester – Application for Premises Licence

We wish to strongly object to the above application. If granted in the terms applied for the licence would permit, on any day of the week the following activities:

- Live performances, music and dancing until 3am;
- Alcohol sales until 2.30am;
- Continuous film showings 24 hours a day;
- Late night refreshments until 5am.

These proposals would generate significant activity in the town centre throughout the night and, in particular, a high level of vehicle movements into and out of the car park above the cinema and along Manorsfield Road. This would impact seriously on the amenities of nearby residents, especially in Hanover Gardens, Hunt Close and St John's Street. We would also foresee a parking issue of vehicles parking in the above areas, some of which are only protected by restrictions between 8.00am and 6.00pm Monday to Saturday. We are also apprehensive about the risk of attendant anti-social behaviour throughout the town centre and an increased need for police presence.

We are of the view that for these activities to be carried on during the quiet hours will amount to a public nuisance. We note that under its Statement of Licensing Policy the prevention of such nuisance is an objective to which the District Council is committed in exercising its licensing functions.

We believe that a licence should be granted that would enable activities upto 11pm, accepting that on Fridays and Saturdays it would be reasonable to extend this to 12 midnight.

Yours

Cllr Richard and Mrs E Mould

Claire Bold

From: MOULD RICHARD [richard.mould51@ntlworld.com]
Sent: 23 October 2012 16:26
To: Licensing
Cc: John Leverton
Subject: Vue Cinema Application

Claire Bold Licensing Team Leader

Claire

I have just been passed a copy of the e-mail from Stuart and Paula Clark-Dunn re the above (you will no doubt have observed that I was not copied). I thought that it would be useful to correct some of the "facts" they have set out.

Whilst the development is perhaps not the most attractive building in Bicester it is welcomed by the majority of residents

The development whilst promoting considerable more traffic movement when complete is unlikely to cause significant disruption to the lives of those living closest to it.

The parking issue does cause concern us particularly if there are charges for evening parking when drivers are likely to seek free alternatives such as Hanover Gardens, Hunt Close etc.

I would dispute the allegation that construction runs from 6.00am to 6.00pm. Living in one of the closest houses to the development we are certainly not aware of work commencing prior to 7.30am and on most days finishing at 5.30pm. As for weekend working 7.30am on Saturday until midday is the norm and Sunday has only been worked to facilitate the paving of Crown Walk so that inconvenience to shoppers is kept to a minimum.

For the purpose of the licencing of the cinema the only real argument is that of noise pollution.

All of the residents agree that operating into the early hours will produce some noise when cinema goers leave the premises. Up to midnight this is likely to be lost in the general background noise however after midnight it can become obtrusive. I believe it would be more realistic to have a cut-off at midnight for at least one year with perhaps an allowance of perhaps twelve "12.01 nights" per year. If these prove that noise is not an issue then it may be possible to extend the number.

Residents generally welcome the cinema as part of the overall development.



Stocks 7 Hunt Close Bicester OX26 6HX

Licensing Department
Cherwell District Council
Bodicote House
Bodicote
Banbury OX15 4AA

Dear Sirs

reference: P.A. for Vue Cinema, Bure Place, Bicester

My husband and I wish to formally complain about the above application which would extend the cinema's current permission.viz showing films only during reasonable hours. The new application it *totally* unacceptable to us and also we imagine to the rest of those living in the vicinity.

At the best of times Bicester is plagued with late night revelers with their shouting and loud behavior and to grant a licence as proposed would exacerbate this immensely and certainly not be acceptable. We. therefore, wish our name to be entered on the "NO"s list. Thank you.

Yours faithfully

A handwritten signature in cursive script, appearing to read "Percy".

for
Mr.D. and Mrs.C. Percy

12 Hunt Close
Bicester
Oxon
OX26 6HX

Licensing Department
Cherwell District Council
Bodicote House
Bodicote
Banbury
OX15 4AA



13 Oct 2010

Dear Sir or Madam

Vue Cinema Bure Place Bicester OX26 6FA Licence Application

I would like to reiterate the comments made by one of my neighbours.

We would support refusal of the requested licensing hours for the following reasons:-

- The current town centre development should not have received planning permission because of its close proximity to existing domestic and retirement dwellings besides the total lack of a proper infrastructure to support such a complex.
- 24/7 operations totally flaunt any green policies.
- Extensive hours will bring about additional noise and light pollution.
- Increased traffic and atmospheric pollution.
- Increased burden on police authority and Environmental Health dealing with what will be increased complaints from residential owners.
- Increased incidences of drunken behaviour which other major Cities are already trying to tackle and an issue which current licensing and planning authorities should be legislating or deciding against as stated in the Act. The Act is based upon promotion of the following four licensing objectives:
 1. the prevention of crime and disorder
 2. the prevention of public nuisance
 3. public safety
 4. the protection of children from harm.
- Increased public transport opposite domestic dwellings.
- Approval of such hours would require an application to the European Court in respect of Human Rights of existing residents.

Yours faithfully

A handwritten signature in black ink, appearing to read "M Mountain".

Miss M Mountain

24 Hanover Gardens
Manorsfield Road
Bicester
OX26 6D

Cherwell District Council
Licensing Department
Bodicote House
Bodicote
Banbury
OX15 4AA



Dear Sir,

**VUE CINEMA, BURE PLACE, BICESTER - APPLICATION FOR PREMISES LICENCE
SECTION 17 LICENSING ACT 2003**

I am writing to object to this application. If granted, the licence would allow live performances, music and dancing until 3am; alcohol sales until 2.30am; films showing 24 hours a day and late night refreshments until 5am.

These proposals would generate significant activity in the town centre throughout the night - and particularly a high level of vehicle movements in and out of the car park above the cinema and along Manorsfield Road. This would impact seriously on nearby residents of St John's Street and Hunt Close but especially Hanover Gardens where I live. Hanover Gardens is a retirement estate of 69 flats - home to some 75 elderly people.

I am apprehensive about the risk of increased anti-social behaviour throughout the town centre and along Manorsfield Road, and the need for an increased police presence. Cherwell DC's Statement of Licensing Policy states that the Council is committed to preventing public nuisance when exercising its licensing function - allowing this licence in its current form will flout that.

I would ask that any licence that is granted does not allow activities to continue after 11pm during the week and after 12 midnight at the weekend.

Yours faithfully, MRS NANCY WEBB

Nancy Webb



16, Hanover Gardens
Bicester
OX26

6DP.

16.10.12.

Dear Sir/Madam,

As you can see from the above address we live opposite the new site for Sainsburys and Vue Cinema. While we are all for the Supermarket and cinema we have become concerned about the proposed licensing hours. Surely such a late licence is not necessary and with Subways nearby with their licence we feel this is a recipe for a lot of late night trouble, i.e.:- loud drunken behaviour, fighting and vandalising. We live right by this cinema and the last thing we need is

noise and trouble outside ~~our~~ ^{our} flats at
night! Therefore we object to this
licence going ahead.

Yours Sincerely

Mr & Mrs. P. Rudge

31 Hanover Gardens
Manorsfield Road
Bicester
OX26 6D G

16/10/12

Cherwell District Council
Licensing Department
Bodicote House
Bodicote
Banbury
OX15 4AA



Dear Sir,

**VUE CINEMA, BURE PLACE, BICESTER - APPLICATION FOR PREMISES LICENCE
SECTION 17 LICENSING ACT 2003**

I am writing to object to this application. If granted, the licence would allow live performances, music and dancing until 3am; alcohol sales until 2.30am; films showing 24 hours a day and late night refreshments until 5am.

These proposals would generate significant activity in the town centre throughout the night - and particularly a high level of vehicle movements in and out of the car park above the cinema and along Manorsfield Road. This would impact seriously on nearby residents of St John's Street and Hunt Close but especially Hanover Gardens where I live. Hanover Gardens is a retirement estate of 69 flats - home to some 75 elderly people.

I am apprehensive about the risk of increased anti-social behaviour throughout the town centre and along Manorsfield Road, and the need for an increased police presence. Cherwell DC's Statement of Licensing Policy states that the Council is committed to preventing public nuisance when exercising its licensing function - allowing this licence in its current form will flout that.

I would ask that any licence that is granted does not allow activities to continue after 11pm during the week and after 12 midnight at the weekend.

Yours faithfully,

A handwritten signature in cursive script, appearing to read "A Faulkner".

MRS A. FAULKNER

34 Hanover Gardens
Manorsfield Road
Bicester
OX26 6DG

16/10/12

Cherwell District Council
Licensing Department
Bodicote House
Bodicote
Banbury
OX15 4AA



Dear Sir,

**VUE CINEMA, BURE PLACE, BICESTER - APPLICATION FOR PREMISES LICENCE
SECTION 17 LICENSING ACT 2003**

I am writing to object to this application. If granted, the licence would allow live performances, music and dancing until 3am; alcohol sales until 2.30am; films showing 24 hours a day and late night refreshments until 5am.

These proposals would generate significant activity in the town centre throughout the night - and particularly a high level of vehicle movements in and out of the car park above the cinema and along Manorsfield Road. This would impact seriously on nearby residents of St John's Street and Hunt Close but especially Hanover Gardens where I live. Hanover Gardens is a retirement estate of 69 flats - home to some 75 elderly people.

I am apprehensive about the risk of increased anti-social behaviour throughout the town centre and along Manorsfield Road, and the need for an increased police presence. Cherwell DC's Statement of Licensing Policy states that the Council is committed to preventing public nuisance when exercising its licensing function - allowing this licence in its current form will flout that.

I would ask that any licence that is granted does not allow activities to continue after 11pm during the week and after 12 midnight at the weekend.

Yours faithfully,

Pamela P. Butler

MRS P. BUTLER

38 Hanover Gardens
Manorsfield Road
Bicester
OX26 6DG



16/10/12

Cherwell District Council
Licensing Department
Bodicote House
Bodicote
Banbury
OX15 4AA

Dear Sir,

**VUE CINEMA, BURE PLACE, BICESTER - APPLICATION FOR PREMISES LICENCE
SECTION 17 LICENSING ACT 2003**

I am writing to object to this application. If granted, the licence would allow live performances, music and dancing until 3am; alcohol sales until 2.30am; films showing 24 hours a day and late night refreshments until 5am.

These proposals would generate significant activity in the town centre throughout the night - and particularly a high level of vehicle movements in and out of the car park above the cinema and along Manorsfield Road. This would impact seriously on nearby residents of St John's Street and Hunt Close but especially Hanover Gardens where I live. Hanover Gardens is a retirement estate of 69 flats - home to some 75 elderly people.

I am apprehensive about the risk of increased anti-social behaviour throughout the town centre and along Manorsfield Road, and the need for an increased police presence. Cherwell DC's Statement of Licensing Policy states that the Council is committed to preventing public nuisance when exercising its licensing function - allowing this licence in its current form will flout that.

I would ask that any licence that is granted does not allow activities to continue after 11pm during the week and after 12 midnight at the weekend.

Yours faithfully,

A handwritten signature in cursive script that reads "R Hardy". The signature is written in dark ink and is positioned above a horizontal line.

MR R. HARDY

50 Hanover Gardens
Manorsfield Road
Bicester
OX26 6D



18/10/12

Cherwell District Council
Licensing Department
Bodicote House
Bodicote
Banbury
OX15 4AA

Dear Sir,

**VUE CINEMA, BURE PLACE, BICESTER - APPLICATION FOR PREMISES LICENCE
SECTION 17 LICENSING ACT 2003**

I am writing to object to this application. If granted, the licence would allow live performances, music and dancing until 3am; alcohol sales until 2.30am; films showing 24 hours a day and late night refreshments until 5am.

These proposals would generate significant activity in the town centre throughout the night - and particularly a high level of vehicle movements in and out of the car park above the cinema and along Manorsfield Road. This would impact seriously on nearby residents of St John's Street and Hunt Close but especially Hanover Gardens where I live. Hanover Gardens is a retirement estate of 69 flats - home to some 75 elderly people.

I am apprehensive about the risk of increased anti-social behaviour throughout the town centre and along Manorsfield Road, and the need for an increased police presence. Cherwell DC's Statement of Licensing Policy states that the Council is committed to preventing public nuisance when exercising its licensing function - allowing this licence in its current form will flout that.

I would ask that any licence that is granted does not allow activities to continue after 11pm during the week and after 12 midnight at the weekend.

Yours faithfully,

A handwritten signature in cursive script, appearing to read "Mrs J. Allix".

MRS J. ALLIX

51 Hanover Gardens
Manorsfield Road
Bicester
OX26 6D

Cherwell District Council
Licensing Department
Bodicote House
Bodicote
Banbury
OX15 4AA



16/10/12

Dear Sir,

**VUE CINEMA, BURE PLACE, BICESTER - APPLICATION FOR PREMISES LICENCE
SECTION 17 LICENSING ACT 2003**

I am writing to object to this application. If granted, the licence would allow live performances, music and dancing until 3am; alcohol sales until 2.30am; films showing 24 hours a day and late night refreshments until 5am.

These proposals would generate significant activity in the town centre throughout the night - and particularly a high level of vehicle movements in and out of the car park above the cinema and along Manorsfield Road. This would impact seriously on nearby residents of St John's Street and Hunt Close but especially Hanover Gardens where I live. Hanover Gardens is a retirement estate of 69 flats - home to some 75 elderly people.

I am apprehensive about the risk of increased anti-social behaviour throughout the town centre and along Manorsfield Road, and the need for an increased police presence. Cherwell DC's Statement of Licensing Policy states that the Council is committed to preventing public nuisance when exercising its licensing function - allowing this licence in its current form will flout that.

I would ask that any licence that is granted does not allow activities to continue after 11pm during the week and after 12 midnight at the weekend.

Yours faithfully,

W J King

MR W. J. KING



66, Hanover Gardens
Manorsfield Road
Bicester
OX26 6D

Cherwell District Council
Licensing Department
Bodicote House
Bodicote
Banbury
OX15 4AA

Dear Sir,

**VUE CINEMA, BURE PLACE, BICESTER - APPLICATION FOR PREMISES LICENCE
SECTION 17 LICENSING ACT 2003**

I am writing to object to this application. If granted, the licence would allow live performances, music and dancing until 3am; alcohol sales until 2.30am; films showing 24 hours a day and late night refreshments until 5am.

These proposals would generate significant activity in the town centre throughout the night - and particularly a high level of vehicle movements in and out of the car park above the cinema and along Manorsfield Road. This would impact seriously on nearby residents of St John's Street and Hunt Close but especially Hanover Gardens where I live. Hanover Gardens is a retirement estate of 69 flats - home to some 75 elderly people.

I am apprehensive about the risk of increased anti-social behaviour throughout the town centre and along Manorsfield Road, and the need for an increased police presence. Cherwell DC's Statement of Licensing Policy states that the Council is committed to preventing public nuisance when exercising its licensing function - allowing this licence in its current form will flout that.

I would ask that any licence that is granted does not allow activities to continue after 11pm during the week and after 12 midnight at the weekend.

Yours faithfully,

Florence Barnsley

FLORENCE BARNSELEY.



47
Hanover Gardens
Manorsfield Road
Bicester
OX26 6D

16 Oct 2012

Cherwell District Council
Licensing Department
Bodicote House
Bodicote
Banbury
OX15 4AA

Dear Sir,

**VUE CINEMA, BURE PLACE, BICESTER - APPLICATION FOR PREMISES LICENCE
SECTION 17 LICENSING ACT 2003**

I am writing to object to this application. If granted, the licence would allow live performances, music and dancing until 3am; alcohol sales until 2.30am; films showing 24 hours a day and late night refreshments until 5am.

These proposals would generate significant activity in the town centre throughout the night - and particularly a high level of vehicle movements in and out of the car park above the cinema and along Manorsfield Road. This would impact seriously on nearby residents of St John's Street and Hunt Close but especially Hanover Gardens where I live. Hanover Gardens is a retirement estate of 69 flats - home to some 75 elderly people.

I am apprehensive about the risk of increased anti-social behaviour throughout the town centre and along Manorsfield Road, and the need for an increased police presence. Cherwell DC's Statement of Licensing Policy states that the Council is committed to preventing public nuisance when exercising its licensing function - allowing this licence in its current form will flout that.

I would ask that any licence that is granted does not allow activities to continue after 11pm during the week and after 12 midnight at the weekend.

Yours faithfully, *H.J. Robertson*



12 . Hanover Gardens
Manorsfield Road
Bicester
OX26 6D

Cherwell District Council
Licensing Department
Bodicote House
Bodicote
Banbury
OX15 4AA

Dear Sir,

**VUE CINEMA, BURE PLACE, BICESTER - APPLICATION FOR PREMISES LICENCE
SECTION 17 LICENSING ACT 2003**

I am writing to object to this application. If granted, the licence would allow live performances, music and dancing until 3am; alcohol sales until 2.30am; films showing 24 hours a day and late night refreshments until 5am.

These proposals would generate significant activity in the town centre throughout the night - and particularly a high level of vehicle movements in and out of the car park above the cinema and along Manorsfield Road. This would impact seriously on nearby residents of St John's Street and Hunt Close but especially Hanover Gardens where I live. Hanover Gardens is a retirement estate of 69 flats - home to some 75 elderly people.

I am apprehensive about the risk of increased anti-social behaviour throughout the town centre and along Manorsfield Road, and the need for an increased police presence. Cherwell DC's Statement of Licensing Policy states that the Council is committed to preventing public nuisance when exercising its licensing function - allowing this licence in its current form will flout that.

I would ask that any licence that is granted does not allow activities to continue after 11pm during the week and after 12 midnight at the weekend.

Yours faithfully,

Mrs J. D. SPENCER



9 Hanover Gardens
Manorsfield Road
Bicester
OX26 6D

Cherwell District Council
Licensing Department
Bodicote House
Bodicote
Banbury
OX15 4AA

Dear Sir,

**VUE CINEMA, BURE PLACE, BICESTER - APPLICATION FOR PREMISES LICENCE
SECTION 17 LICENSING ACT 2003**

I am writing to object to this application. If granted, the licence would allow live performances, music and dancing until 3am; alcohol sales until 2.30am; films showing 24 hours a day and late night refreshments until 5am.

These proposals would generate significant activity in the town centre throughout the night - and particularly a high level of vehicle movements in and out of the car park above the cinema and along Manorsfield Road. This would impact seriously on nearby residents of St John's Street and Hunt Close but especially Hanover Gardens where I live. Hanover Gardens is a retirement estate of 69 flats - home to some 75 elderly people.

I am apprehensive about the risk of increased anti-social behaviour throughout the town centre and along Manorsfield Road, and the need for an increased police presence. Cherwell DC's Statement of Licensing Policy states that the Council is committed to preventing public nuisance when exercising its licensing function - allowing this licence in its current form will flout that.

I would ask that any licence that is granted does not allow activities to continue after 11pm during the week and after 12 midnight at the weekend.

Yours faithfully,

RASHBY
ROBERT A SHIRLEY



NO 6
Hanover Gardens
Manorsfield Road
Bicester
OX26 6D
16/10/2012.

Cherwell District Council
Licensing Department
Bodicote House
Bodicote
Banbury
OX15 4AA

Dear Sir,

**VUE CINEMA, BURE PLACE, BICESTER - APPLICATION FOR PREMISES LICENCE
SECTION 17 LICENSING ACT 2003**

I am writing to object to this application. If granted, the licence would allow live performances, music and dancing until 3am; alcohol sales until 2.30am; films showing 24 hours a day and late night refreshments until 5am.

These proposals would generate significant activity in the town centre throughout the night - and particularly a high level of vehicle movements in and out of the car park above the cinema and along Manorsfield Road. This would impact seriously on nearby residents of St John's Street and Hunt Close but especially Hanover Gardens where I live. Hanover Gardens is a retirement estate of 69 flats - home to some 75 elderly people.

I am apprehensive about the risk of increased anti-social behaviour throughout the town centre and along Manorsfield Road, and the need for an increased police presence. Cherwell DC's Statement of Licensing Policy states that the Council is committed to preventing public nuisance when exercising its licensing function - allowing this licence in its current form will flout that.

I would ask that any licence that is granted does not allow activities to continue after 11pm during the week and after 12 midnight at the weekend.

Yours faithfully,

BRIAN FOX



8 Hanover Gardens
Manorsfield Road
Bicester
OX26 6D

16/10/12

Cherwell District Council
Licensing Department
Bodicote House
Bodicote
Banbury
OX15 4AA

Dear Sir,

**VUE CINEMA, BURE PLACE, BICESTER - APPLICATION FOR PREMISES LICENCE
SECTION 17 LICENSING ACT 2003**

We are writing to object to this application. If granted, the licence would allow live performances, music and dancing until 3am; alcohol sales until 2.30am; films showing 24 hours a day and late night refreshments until 5am.

These proposals would generate significant activity in the town centre throughout the night - and particularly a high level of vehicle movements in and out of the car park above the cinema and along Manorsfield Road. This would impact seriously on nearby residents of St John's Street and Hunt Close but especially Hanover Gardens where we live. Hanover Gardens is a retirement estate of 69 flats - home to some 75 elderly people.

We are apprehensive about the risk of increased anti-social behaviour throughout the town centre and along Manorsfield Road, and the need for an increased police presence. Cherwell DC's Statement of Licensing Policy states that the Council is committed to preventing public nuisance when exercising its licensing function - allowing this licence in its current form will flout that.

We would ask that any licence that is granted does not allow activities to continue after 11pm during the week and after 12 midnight at the weekend.

Yours faithfully,

OBJECT ANSWAR

NO

MR R + MRS S HIGGINS

MR & MRS R. S. Higgins



20 Hanover Gardens
Manorsfield Road
Bicester
OX26 6D

16/10/12

Cherwell District Council
Licensing Department
Bodicote House
Bodicote
Banbury
OX15 4AA

Dear Sir,

**VUE CINEMA, BURE PLACE, BICESTER - APPLICATION FOR PREMISES LICENCE
SECTION 17 LICENSING ACT 2003**

I am writing to object to this application. If granted, the licence would allow live performances, music and dancing until 3am; alcohol sales until 2.30am; films showing 24 hours a day and late night refreshments until 5am.

These proposals would generate significant activity in the town centre throughout the night - and particularly a high level of vehicle movements in and out of the car park above the cinema and along Manorsfield Road. This would impact seriously on nearby residents of St John's Street and Hunt Close but especially Hanover Gardens where I live. Hanover Gardens is a retirement estate of 69 flats - home to some 75 elderly people.

I am apprehensive about the risk of increased anti-social behaviour throughout the town centre and along Manorsfield Road, and the need for an increased police presence. Cherwell DC's Statement of Licensing Policy states that the Council is committed to preventing public nuisance when exercising its licensing function - allowing this licence in its current form will flout that.

I would ask that any licence that is granted does not allow activities to continue after 11pm during the week and after 12 midnight at the weekend.

Yours faithfully,

Do NOT WANT ANSWER NO

MRS J BOWEN
Mrs J Bowen

11 Hanover Gardens
Manorsfield Road
Bicester
OX26 6D

16/10/12



Cherwell District Council
Licensing Department
Bodicote House
Bodicote
Banbury
OX15 4AA

Dear Sir,

**VUE CINEMA, BURE PLACE, BICESTER - APPLICATION FOR PREMISES LICENCE
SECTION 17 LICENSING ACT 2003**

We are writing to object to this application. If granted, the licence would allow live performances, music and dancing until 3am; alcohol sales until 2.30am; films showing 24 hours a day and late night refreshments until 5am.

These proposals would generate significant activity in the town centre throughout the night - and particularly a high level of vehicle movements in and out of the car park above the cinema and along Manorsfield Road. This would impact seriously on nearby residents of St John's Street and Hunt Close but especially Hanover Gardens where we live. Hanover Gardens is a retirement estate of 69 flats - home to some 75 elderly people.

We are apprehensive about the risk of increased anti-social behaviour throughout the town centre and along Manorsfield Road, and the need for an increased police presence. Cherwell DC's Statement of Licensing Policy states that the Council is committed to preventing public nuisance when exercising its licensing function - allowing this licence in its current form will flout that.

We would ask that any licence that is granted does not allow activities to continue after 11pm during the week and after 12 midnight at the weekend.

Yours faithfully,

MR + MRS G ROBINSON



Hanover Gardens
Manorsfield Road
Bicester
OX26 6D

Cherwell District Council
Licensing Department
Bodicote House
Bodicote
Banbury
OX15 4AA

Dear Sir,

**VUE CINEMA, BURE PLACE, BICESTER - APPLICATION FOR PREMISES LICENCE
SECTION 17 LICENSING ACT 2003**

I am writing to object to this application. If granted, the licence would allow live performances, music and dancing until 3am; alcohol sales until 2.30am; films showing 24 hours a day and late night refreshments until 5am.

These proposals would generate significant activity in the town centre throughout the night - and particularly a high level of vehicle movements in and out of the car park above the cinema and along Manorsfield Road. This would impact seriously on nearby residents of St John's Street and Hunt Close but especially Hanover Gardens where I live. Hanover Gardens is a retirement estate of 69 flats - home to some 75 elderly people.

I am apprehensive about the risk of increased anti-social behaviour throughout the town centre and along Manorsfield Road, and the need for an increased police presence. Cherwell DC's Statement of Licensing Policy states that the Council is committed to preventing public nuisance when exercising its licensing function - allowing this licence in its current form will flout that.

I would ask that any licence that is granted does not allow activities to continue after 11pm during the week and after 12 midnight at the weekend.

Yours faithfully,

D CASTLE

FLAT 29.



P. BOWEN

5 HANOVER GARDENS
BICESTER
OX26 6JP

SIR

16.10.12

I am writing to you today with my
OBJECTION'S AND REASONS, to the NEW
LICENSING HOURS, that are being proposed
for the YUE CINEMA in BICESTER.

We already have to put up with cars
parking on our Estate all day, and up to 11.30pm
which is when the SUBWAY STOP closes.

As I live almost opposite subway we
have to put up with empty cars and food
being thrown out of cars, but for me the worst
reason is that in the evenings their car
Headlights are a real problem, as they shine
right into my Bedroom, windows.

P70

As I suffer with RHEUMATOID ARTHRITIS
it's hard enough getting to sleep, the thought
of Car Lights all night long is Horrendous.
People know they are not supposed to Park
here, but they take a chance of not getting
caught rather than pay for Parking.

So. Moan-Moan, Grumble Grumble.
hope you can help save my and others
Sanity.

Thank you.

Yours Sincerely

Phyllis Bower

59 Hanover Gardens
Manorsfield Road
Bicester
OX26 6DQ

Cherwell District Council
Licensing Department
Bodicote House
Bodicote
Banbury
OX15 4AA



Dear Sir,

**VUE CINEMA, BURE PLACE, BICESTER - APPLICATION FOR PREMISES LICENCE
SECTION 17 LICENSING ACT 2003**

I am writing to object to this application. If granted, the licence would allow live performances, music and dancing until 3am; alcohol sales until 2.30am; films showing 24 hours a day and late night refreshments until 5am.

These proposals would generate significant activity in the town centre throughout the night - and particularly a high level of vehicle movements in and out of the car park above the cinema and along Manorsfield Road. This would impact seriously on nearby residents of St John's Street and Hunt Close but especially Hanover Gardens where I live. Hanover Gardens is a retirement estate of 69 flats - home to some 75 elderly people.

I am apprehensive about the risk of increased anti-social behaviour throughout the town centre and along Manorsfield Road, and the need for an increased police presence. Cherwell DC's Statement of Licensing Policy states that the Council is committed to preventing public nuisance when exercising its licensing function - allowing this licence in its current form will flout that.

I would ask that any licence that is granted does not allow activities to continue after 11pm during the week and after 12 midnight at the weekend.

Yours faithfully,

P M Dyson (59)

MRS PATRICIA DYSON

56 Hanover Gardens
Manorsfield Road
Bicester
OX26 6DQ



Cherwell District Council
Licensing Department
Bodicote House
Bodicote
Banbury
OX15 4AA

Dear Sir,

**VUE CINEMA, BURE PLACE, BICESTER - APPLICATION FOR PREMISES LICENCE
SECTION 17 LICENSING ACT 2003**

I am writing to object to this application. If granted, the licence would allow live performances, music and dancing until 3am; alcohol sales until 2.30am; films showing 24 hours a day and late night refreshments until 5am.

These proposals would generate significant activity in the town centre throughout the night - and particularly a high level of vehicle movements in and out of the car park above the cinema and along Manorsfield Road. This would impact seriously on nearby residents of St John's Street and Hunt Close but especially Hanover Gardens where I live. Hanover Gardens is a retirement estate of 69 flats - home to some 75 elderly people.

I am apprehensive about the risk of increased anti-social behaviour throughout the town centre and along Manorsfield Road, and the need for an increased police presence. Cherwell DC's Statement of Licensing Policy states that the Council is committed to preventing public nuisance when exercising its licensing function - allowing this licence in its current form will flout that.

I would ask that any licence that is granted does not allow activities to continue after 11pm during the week and after 12 midnight at the weekend.

Yours faithfully,

P. Ayris (56)

MRS. PEGGY AYRIS

451 → Hanover Gardens
Manorsfield Road
Bicester
OX26 6D9



Cherwell District Council
Licensing Department
Bodicote House
Bodicote
Banbury
OX15 4AA

Dear Sir,

**VUE CINEMA, BURE PLACE, BICESTER - APPLICATION FOR PREMISES LICENCE
SECTION 17 LICENSING ACT 2003**

I am writing to object to this application. If granted, the licence would allow live performances, music and dancing until 3am; alcohol sales until 2.30am; films showing 24 hours a day and late night refreshments until 5am.

These proposals would generate significant activity in the town centre throughout the night - and particularly a high level of vehicle movements in and out of the car park above the cinema and along Manorsfield Road. This would impact seriously on nearby residents of St John's Street and Hunt Close but especially Hanover Gardens where I live. Hanover Gardens is a retirement estate of 69 flats - home to some 75 elderly people.

I am apprehensive about the risk of increased anti-social behaviour throughout the town centre and along Manorsfield Road, and the need for an increased police presence. Cherwell DC's Statement of Licensing Policy states that the Council is committed to preventing public nuisance when exercising its licensing function - allowing this licence in its current form will flout that.

I would ask that any licence that is granted does not allow activities to continue after 11pm during the week and after 12 midnight at the weekend.

Yours faithfully, *Ms A Blatter*
MRS A BLATTER

44 Hanover Gardens
Manorsfield Road
Bicester
OX26 6D9

Cherwell District Council
Licensing Department
Bodicote House
Bodicote
Banbury
OX15 4AA



Dear Sir,

**VUE CINEMA, BURE PLACE, BICESTER - APPLICATION FOR PREMISES LICENCE
SECTION 17 LICENSING ACT 2003**

I am writing to object to this application. If granted, the licence would allow live performances, music and dancing until 3am; alcohol sales until 2.30am; films showing 24 hours a day and late night refreshments until 5am.

These proposals would generate significant activity in the town centre throughout the night - and particularly a high level of vehicle movements in and out of the car park above the cinema and along Manorsfield Road. This would impact seriously on nearby residents of St John's Street and Hunt Close but especially Hanover Gardens where I live. Hanover Gardens is a retirement estate of 69 flats - home to some 75 elderly people.

I am apprehensive about the risk of increased anti-social behaviour throughout the town centre and along Manorsfield Road, and the need for an increased police presence. Cherwell DC's Statement of Licensing Policy states that the Council is committed to preventing public nuisance when exercising its licensing function - allowing this licence in its current form will flout that.

I would ask that any licence that is granted does not allow activities to continue after 11pm during the week and after 12 midnight at the weekend.

Yours faithfully,

Audrey K. Spellar.

AUDREY K SPELLAR.

18.10.2012

PROJECT SPARK

16 Hunt Close, Bicester



Dear Sirs

Re. Vue Entertainment Ltd. Application

As a resident of Bicester, I was delighted, initially, that the young of this growing town were being given an Entertainment Centre. For years, having seen bottles, cans and occasional needles after Friday & Saturday nights regular drinking sessions in Reynolds Court & Tollgate, I hoped that the new cinema would provide a distraction from these weekend ill-disciplines. Sadly, I am now outraged.

- ① 24/7 films is ridiculous. This was tried out in London in 1970/80's & all lost money. Most were closed in the 1990's.
- ② Licensing hours to 2.30AM or 5.30AM is preposterous & anti-social. By law, pubs have to close ~~by law~~ at 11pm. It is totally inappropriate, considering the old age residents of Harover Estate & Hunt Close opposite.

I am all for teenagers having fun, but not at the expense of the rest of the Bicester community. Encouraging kids to drink to excess, encourages bad behaviour & disorder. Ask the police.

- ③ The police station in Bicester is closed Sunday & Monday. It is open Tuesday - Saturday 9AM - 5pm. Who will be around to keep the peace when there is a disturbance? The suggested licensing hours are a recipe for disaster & totally irresponsible & open to culpable negligence.

As an author and journalist, I will do everything in my power to prevent this, even if it means involving the National Press.

Yours sincerely

Sally Trench

Registered Address: 3rd Floor, 12 Gough Square, London, EC4A 3DW

Tel: 020 7936 1910

Email: office@projectspark.org.uk

Fax: 020 7936 4161

Website: www.projectspark.org.uk

Director: Sally Trench

Registered Charity No.261255

Trustees: Angus Boyd-Heron (Chairman), Susan Simmons, Louisa Hook, Eva Ramirez

7 Hanover Gardens
Manorsfield Road
Bicester
OX26 6D

Cherwell District Council
Licensing Department
Bodicote House
Bodicote
Banbury
OX15 4AA



Dear Sir,

**VUE CINEMA, BURE PLACE, BICESTER - APPLICATION FOR PREMISES LICENCE
SECTION 17 LICENSING ACT 2003**

I am writing to object to this application. If granted, the licence would allow live performances, music and dancing until 3am; alcohol sales until 2.30am; films showing 24 hours a day and late night refreshments until 5am.

These proposals would generate significant activity in the town centre throughout the night - and particularly a high level of vehicle movements in and out of the car park above the cinema and along Manorsfield Road. This would impact seriously on nearby residents of St John's Street and Hunt Close but especially Hanover Gardens where I live. Hanover Gardens is a retirement estate of 69 flats - home to some 75 elderly people.

I am apprehensive about the risk of increased anti-social behaviour throughout the town centre and along Manorsfield Road, and the need for an increased police presence. Cherwell DC's Statement of Licensing Policy states that the Council is committed to preventing public nuisance when exercising its licensing function - allowing this licence in its current form will flout that.

I would ask that any licence that is granted does not allow activities to continue after 11pm during the week and after 12 midnight at the weekend.

Yours faithfully,

Minam I. Layman

Parkside
8, Hunt Close
Bicester
OX26 6HX

Licensing Department
Cherwell District Council
Bodicote
Banbury
OX15 4AA



17th October 2012

Dear Sir/Madam,

Vue Cinema Bure Place Bicester OX26 6FA - Licence Application

With reference to the proposed application request for Vue Cinema to play live and recorded music, plus the performance of dance Sunday to Saturday with the sale of alcohol 24/7 in the town centre - will only add to the already alcohol fuelled society which is unacceptable, even more so given it's position!

This type of venue needs to be on the outskirts of the town where the noise from parking, and club goers will not disturb the residents close by. Such 24/7 operations are not in line with any green policies! The retirement dwellings across the road and that of Hunt Close along with other residents in the town will have to endure the fallout from such approval!! Parking in Hunt Close will suffer further unless double yellow lines are introduced..

The extra burden on Police would surely not be welcome on an already reduced force. Increased light pollution and public transport opposite domestic dwellings in the early hours of the morning would be such a burden on residents and police let alone public safety!

Noisy, drunken, intimidating behaviour is already a big problem in the town centre, we are frightened to walk the town after dark! we strongly object to this approval. And, what of our Human Rights as existing residents, would such an approval be required by the European Court??

Yours faithfully

A handwritten signature in black ink, appearing to read "J. Jackson & D.P. Carter".

J. Jackson & D.P. Carter

Hanover Gardens
Manorsfield Road
Bicester
OX26 6D

Cherwell District Council
Licensing Department
Bodicote House
Bodicote
Banbury
OX15 4AA



Dear Sir,

**VUE CINEMA, BURE PLACE, BICESTER - APPLICATION FOR PREMISES LICENCE
SECTION 17 LICENSING ACT 2003**

I am writing to object to this application. If granted, the licence would allow live performances, music and dancing until 3am; alcohol sales until 2.30am; films showing 24 hours a day and late night refreshments until 5am.

These proposals would generate significant activity in the town centre throughout the night - and particularly a high level of vehicle movements in and out of the car park above the cinema and along Manorsfield Road. This would impact seriously on nearby residents of St John's Street and Hunt Close but especially Hanover Gardens where we live. Hanover Gardens is a retirement estate of 69 flats - home to some 75 elderly people.

I am apprehensive about the risk of increased anti-social behaviour throughout the town centre and along Manorsfield Road, and the need for an increased police presence. Cherwell DC's Statement of Licensing Policy states that the Council is committed to preventing public nuisance when exercising its licensing function - allowing this licence in its current form will flout that.

I would ask that any licence that is granted does not allow activities to continue after 11pm during the week and after 12 midnight at the weekend.

Yours faithfully,

J. V. Ricketts (MRS)
22 Hanover Gardens.
Bicester
OX26 6.D.P.

Hanover Gardens
Manorsfield Road
Bicester
OX26 6D

Cherwell District Council
Licensing Department
Bodicote House
Bodicote
Banbury
OX15 4AA



Dear Sir,

**VUE CINEMA, BURE PLACE, BICESTER - APPLICATION FOR PREMISES LICENCE
SECTION 17 LICENSING ACT 2003**

I am writing to object to this application. If granted, the licence would allow live performances, music and dancing until 3am; alcohol sales until 2.30am; films showing 24 hours a day and late night refreshments until 5am.

These proposals would generate significant activity in the town centre throughout the night - and particularly a high level of vehicle movements in and out of the car park above the cinema and along Manorsfield Road. This would impact seriously on nearby residents of St John's Street and Hunt Close but especially Hanover Gardens where we live. Hanover Gardens is a retirement estate of 69 flats - home to some 75 elderly people.

I am apprehensive about the risk of increased anti-social behaviour throughout the town centre and along Manorsfield Road, and the need for an increased police presence. Cherwell DC's Statement of Licensing Policy states that the Council is committed to preventing public nuisance when exercising its licensing function - allowing this licence in its current form will flout that.

I would ask that any licence that is granted does not allow activities to continue after 11pm during the week and after 12 midnight at the weekend.

Yours faithfully,

D. H. Ricketts (MR)
22 Hanover Gardens.
Bicester
OX26 6DP.

43 T. DAVEY.
Hanover Gardens
Manorsfield Road
Bicester
OX26 6D

Cherwell District Council
Licensing Department
Bodicote House
Bodicote
Banbury
OX15 4AA



Dear Sir,

**VUE CINEMA, BURE PLACE, BICESTER - APPLICATION FOR PREMISES LICENCE
SECTION 17 LICENSING ACT 2003**

I am writing to object to this application. If granted, the licence would allow live performances, music and dancing until 3am; alcohol sales until 2.30am; films showing 24 hours a day and late night refreshments until 5am.

These proposals would generate significant activity in the town centre throughout the night - and particularly a high level of vehicle movements in and out of the car park above the cinema and along Manorsfield Road. This would impact seriously on nearby residents of St John's Street and Hunt Close but especially Hanover Gardens where I live. Hanover Gardens is a retirement estate of 69 flats - home to some 75 elderly people.

I am apprehensive about the risk of increased anti-social behaviour throughout the town centre and along Manorsfield Road, and the need for an increased police presence. Cherwell DC's Statement of Licensing Policy states that the Council is committed to preventing public nuisance when exercising its licensing function - allowing this licence in its current form will flout that.

I would ask that any licence that is granted does not allow activities to continue after 11pm during the week and after 12 midnight at the weekend.

Yours faithfully,

MR. T. DAVEY

46

46 Hanover Gardens
Manorsfield Road
Bicester
OX26 6D

Cherwell District Council
Licensing Department
Bodicote House
Bodicote
Banbury
OX15 4AA



Dear Sir,

**VUE CINEMA, BURE PLACE, BICESTER - APPLICATION FOR PREMISES LICENCE
SECTION 17 LICENSING ACT 2003**

I am writing to object to this application. If granted, the licence would allow live performances, music and dancing until 3am; alcohol sales until 2.30am; films showing 24 hours a day and late night refreshments until 5am.

These proposals would generate significant activity in the town centre throughout the night - and particularly a high level of vehicle movements in and out of the car park above the cinema and along Manorsfield Road. This would impact seriously on nearby residents of St John's Street and Hunt Close but especially Hanover Gardens where I live. Hanover Gardens is a retirement estate of 69 flats - home to some 75 elderly people.

I am apprehensive about the risk of increased anti-social behaviour throughout the town centre and along Manorsfield Road, and the need for an increased police presence. Cherwell DC's Statement of Licensing Policy states that the Council is committed to preventing public nuisance when exercising its licensing function - allowing this licence in its current form will flout that.

I would ask that any licence that is granted does not allow activities to continue after 11pm during the week and after 12 midnight at the weekend.

Yours faithfully, 

Hanover Gardens
Manorsfield Road
Eicester
OX26 6D



Cherwell District Council
Licensing Department
Bodicote House
Bodicote
Banbury
OX15 4AA

Dear Sr,

**VUE CINEMA, BURE PLACE, EICESTER - APPLICATION FOR PREMISES LICENCE
SECTION 17 LICENSING ACT 2003**

I am writing to object to this application. If granted, the licence would allow live performances, music and dancing until 3am; alcohol sales until 2.30am; films showing 24 hours a day and late night refreshments until 5am.

These proposals would generate significant activity in the town centre throughout the night - and particularly a high level of vehicle movements in and out of the car park above the cinema and along Manorsfield Road. This would impact seriously on nearby residents of St John's Street and Hunt Close but especially Hanover Gardens where we live. Hanover Gardens is a retirement estate of 69 flats - home to some 75 elderly people.

I am apprehensive about the risk of increased anti-social behaviour throughout the town centre and along Manorsfield Road, and the need for an increased police presence. Cherwell DC's Statement of Licensing Policy states that the Council is committed to preventing public nuisance when exercising its licensing function - allowing this licence in its current form will flout that.

I would ask that any licence that is granted does not allow activities to continue after 11pm during the week and after 12 midnight at the weekend.

Yours faithfully, *Mr G E Adams*



14 Hanover Gardens
Manorsfield Road
Bicester
OX26 6D
19-10-2012

Cherwell District Council
Licensing Department
Bodicote House
Bodicote
Banbury
OX15 4AA

Dear Sir,

**VUE CINEMA, BURE PLACE, BICESTER - APPLICATION FOR PREMISES LICENCE
SECTION 17 LICENSING ACT 2003**

We are writing to object to this application. If granted, the licence would allow live performances, music and dancing until 3am; alcohol sales until 2.30am; films showing 24 hours a day and late night refreshments until 5am.

These proposals would generate significant activity in the town centre throughout the night - and particularly a high level of vehicle movements in and out of the car park above the cinema and along Manorsfield Road. This would impact seriously on nearby residents of St John's Street and Hunt Close but especially Hanover Gardens where we live. Hanover Gardens is a retirement estate of 69 flats - home to some 75 elderly people.

We are apprehensive about the risk of increased anti-social behaviour throughout the town centre and along Manorsfield Road, and the need for an increased police presence. Cherwell DC's Statement of Licensing Policy states that the Council is committed to preventing public nuisance when exercising its licensing function - allowing this licence in its current form will flout that.

We would ask that any licence that is granted does not allow activities to continue after 11pm during the week and after 12 midnight at the weekend.

Yours faithfully,

E. J. DYASON

A. S. DYASON

35 Hanover Gardens
Manorsfield Road
Bicester
OX26 6D G

Cherwell District Council
Licensing Department
Bodicote House
Bodicote
Banbury
OX15 4AA



Dear Sir,

**VUE CINEMA, BUREPLACE, BICESTER - APPLICATION FOR PREMISES LICENCE
SECTION 17 LICENSING ACT 2003**

I am writing to object to this application. If granted, the licence would allow live performances, music and dancing until 3am; alcohol sales until 2.30am; films showing 24 hours a day and late night refreshments until 5am.

These proposals would generate significant activity in the town centre throughout the night - and particularly a high level of vehicle movements in and out of the car park above the cinema and along Manorsfield Road. This would impact seriously on nearby residents of St John's Street and Hunt Close but especially Hanover Gardens where we live. Hanover Gardens is a retirement estate of 69 flats - home to some 75 elderly people.

I am apprehensive about the risk of increased anti-social behaviour throughout the town centre and along Manorsfield Road, and the need for an increased police presence. Cherwell DC's Statement of Licensing Policy states that the Council is committed to preventing public nuisance when exercising its licensing function - allowing this licence in its current form will flout that.

I would ask that any licence that is granted does not allow activities to continue after 11pm during the week and after 12 midnight at the weekend.

Yours faithfully,

Anne Robertson (Mrs)

40 Hanover Gardens
Manorsfield Road
Bicester
OX26 6DG

Cherwell District Council
Licensing Department
Bodicote House
Bodicote
Banbury
OX15 4AA



Dear Sir,

**VUE CINEMA, BURE PLACE, BICESTER - APPLICATION FOR PREMISES LICENCE
SECTION 17 LICENSING ACT 2003**

I am writing to object to this application. If granted, the licence would allow live performances, music and dancing until 3am; alcohol sales until 2.30am; films showing 24 hours a day and late night refreshments until 5am.

These proposals would generate significant activity in the town centre throughout the night - and particularly a high level of vehicle movements in and out of the car park above the cinema and along Manorsfield Road. This would impact seriously on nearby residents of St John's Street and Hunt Close but especially Hanover Gardens where we live. Hanover Gardens is a retirement estate of 69 flats - home to some 75 elderly people.

I am apprehensive about the risk of increased anti-social behaviour throughout the town centre and along Manorsfield Road, and the need for an increased police presence. Cherwell DC's Statement of Licensing Policy states that the Council is committed to preventing public nuisance when exercising its licensing function - allowing this licence in its current form will flout that.

I would ask that any licence that is granted does not allow activities to continue after 11pm during the week and after 12 midnight at the weekend.

Yours faithfully,

Mrs Dorothy Ashwell

D. Ashwell

Claire Bold

From: Griffin Libby [Libby.Griffin@hanover.org.uk]
Sent: 23 October 2012 14:40
To: Claire Bold
Subject: Premises Licence: vue Cinema, Bicester - Objection
Attachments: Map - Vue Cinema proximity to Hanover Gardens Retirement housing & pedestrian exit routes.pdf

Dear Claire

Thank you for making arrangements for some concerned residents of Hanover Gardens and I meet with Kam Dosanjh, Operations Director of Vue Cinemas, last week.

Please count this email as an Objection to Vue’s application for a Premises Licence for their cinema at Bure Place, Bicester.

I object because:

1. The cinema is located opposite residential housing, including retirement housing for older people. The pedestrian exit pathways from the cinema lead directly onto Manorsfield Road, opposite Hanover Gardens. (see map attached). The Cinema will house several screens seating 100-200 people. Each time a film finishes up to 200 people will leave the venue. It is likely that very many of them will exit on foot or by car on to Manorsfield Road, generating a good deal of noise – verbal and mechanical. Mr Dosanjh of Vue has confirmed that they expect to regularly screen films after 10pm and often after 12 midnight. This will lead to late night noise as described and will disturb the residents of Hanover Gardens as they try to sleep.

2. I am concerned that Cherwell’s Anti Social Behaviour Department has not sought the opinions of the Residents of Hanover Gardens before making their comments on the Licence application. I believe that there will be an increased risk of late night crime and disorder in the Manorsfield Road area. Alcohol will be on sale at the venue and, as I have said above, an approved licence for late screenings will see very many people exit the cinema in waves during the evenings. Vue do not plan to have evening security staff. Anti social behaviour outside the venue is likely to be heard and seen by Hanover Gardens Residents, causing them to be scared and anxious in their own homes.

Please let me know when the date and time for the Licence hearing is confirmed.

With thanks.
Yours sincerely

Libby Griffin
Estate Manger

01869 246388

Hanover Gardens, Manorsfield Road,
Bicester, Oxon OX26 6DG

www.hanover.org.uk

Please see the important Legal Notice concerning this email at
<http://www.hanover.org.uk/about-us/legal-notice>

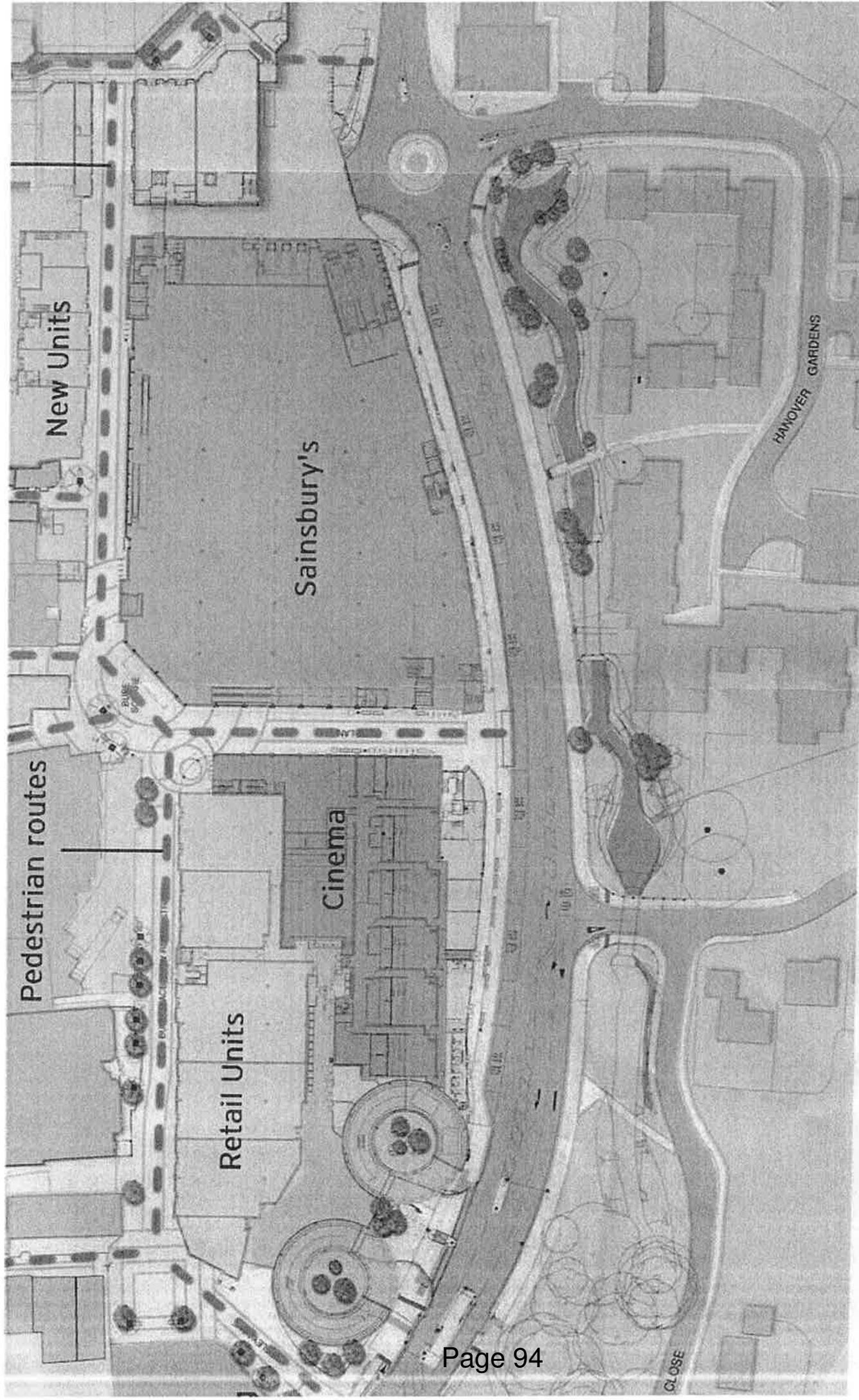

Pedestrian routes

New Units

Sainsbury's

HANOVER GARDENS

Retail Units

Cinema

CLOSE

Application for Premises Licence: Vue Cinema, Bure Place, Bicester

Dear Claire,

I wish to register my concerns regarding this application, not the actual facility which is much needed in Bicester, but the proposed hours of operation, and its likely implications on residents near and around the venue.

I've met with a number of residents in Hanover Gardens and Hunt Close and listened to their concerns, and I appreciate that the Applicant has had a meeting with Hanover residents where their concerns were explained.

My major worries relate, not what happens within the premises, but the impact on residents before and after performances, primarily around parking, noise, and litter.

I'm content that the issue of noise from actual performances can be managed by appropriate design methodology which will ensure that residents will not suffer.

The cinema building, whilst being built as part of the Town Centre re-development and therefore sits in what might be described as the "retail centre", it also sits very close to a residential area, including Hanover Gardens, a residential centre for old persons. Whilst the residents have to accept a considerable increase in general activity as a result of the new development, most of this additional noise will occur during daytime and evenings.

However the cinema application is seeking to operate 24 hours for film, and up to 3am for plays, live music, recorded music, dance, facilities for making music.

Additionally it is seeking permission to provide "refreshments" until 5am, **served both indoors and outdoors.**

It can therefore be very easily presumed that there will be considerable movement of people leaving in the early hours, (to many this will seem the middle of the night).

It is also very easy to presume the vast majority of these people will leave and return to their cars, with the obvious resultant noise. (Cars doors etc.)

Local residents expect, with good reason, that many will have parked in adjacent roads, rather than pay in the new car park.

However the situation is further exacerbated by the fact that the cinema is seeking to serve alcohol throughout performances, albeit to cease serving 30 mins prior to the end of the performance.

I'm sure we all acknowledge that when people have been drinking, over a prolonged period they are likely to create "more noise", and experiences elsewhere show that post "last orders" in areas that have pubs and clubs residents have to endure considerable noise, albeit for a relative shorter period.

With this application residents are likely to be subjected to this noise through the night.

An additional concern, specifically for residents of Hanover Gardens, relate to the sandwich bar, Subway. It is believed that they currently have a 24 hour licence to serve food. To date this has not been exercised, presumably insufficient demand.

However with a cinema, operating right through the night, it's not unreasonable to presume that Subway will review it's actually hours of operating. This would almost certainly create more disturbance, and of course, would almost certainly lead to considerable more litter.

I'm not familiar with how many public houses within the centre of Bicester have extended hours of opening, but should the cinema be granted permission to open, and sell alcohol through the night, one or two pubs might follow suit, even if only occasionally if it made commercial sense. If this were to happen then the impact in terms noise, litter etc., could easily impact even more residents.

Conclusion

I would like the following amendments made to the application>

Section A	Plays	9 am until	Midnight
Section B	Films	9 am until	Midnight (see note below)
Section E	Live Music	9 am until	Midnight
Section F	Recorded Music	9 am until	Midnight
Section G	Dance	9 am until	Midnight
Section I	Facilities for music	9 am until	Midnight
Section J	Facilities for dance	9 am until	Midnight
Section L	Refreshment	10 pm until	Midnight
Section M	Supply of alcohol	Noon until	11:30 pm.

Section O Open to public 9 am until 1 hour after end of performance.

Note. I understand that there are occasions when the application my wish to operate “extended” performances, e.g. back to back films like Star Wars, etc, or for very special releases.

I believe should best be covered by individual applications, like “temporary events” and limited to a certain number per year.

Regards,

Cllr Lawrie Stratford

This page is intentionally left blank

Location Map of Bicester, showing Vue Cinema & Bure Place Development & locations of Interested Parties



1. Bure Place Development
2. Vue Cinema
3. Hanover Gardens
4. Hunt Close
5. Manorsfield Road

Note: Vue Cinema forms part of the new Bure Place Development and this is currently still under construction. Therefore, the precise building's are not shown upon the map as this information was not available at the time of writing the report. Plans showing the actual layout of the Vue Cinema are attached to the application form for the premises licence.

This page is intentionally left blank